

MiraPLY™

PRE-APPLIED/BLINDSIDE WATERPROOFING SYSTEM



February 24, 2020

© 2020 CARLISLE CORPORATION

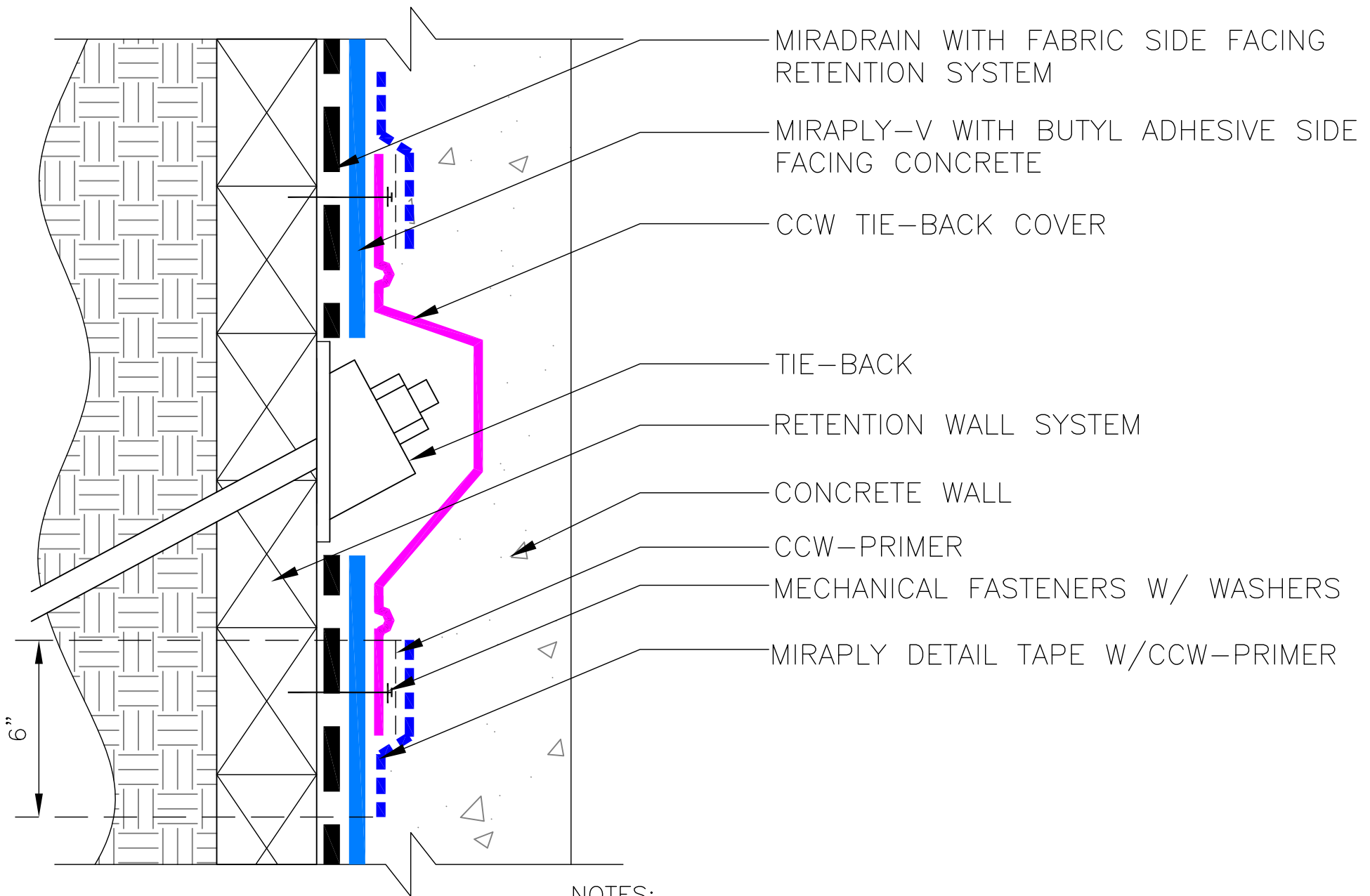

NOTES:

1. Refer to Technical Data Sheets for additional information.

DETAIL IS INTENDED TO BE A GUIDE FOR WATERPROOFING INSTALLATION ONLY.

MiraPLY™ BLINDSIDE WATERPROOFING

02/24/2020

N.T.S.

MP-10

MIRAPLY-V TIE-BACK COVER

CARLISLE
COATINGS & WATERPROOFING

© 2020 CARLISLE CORPORATION

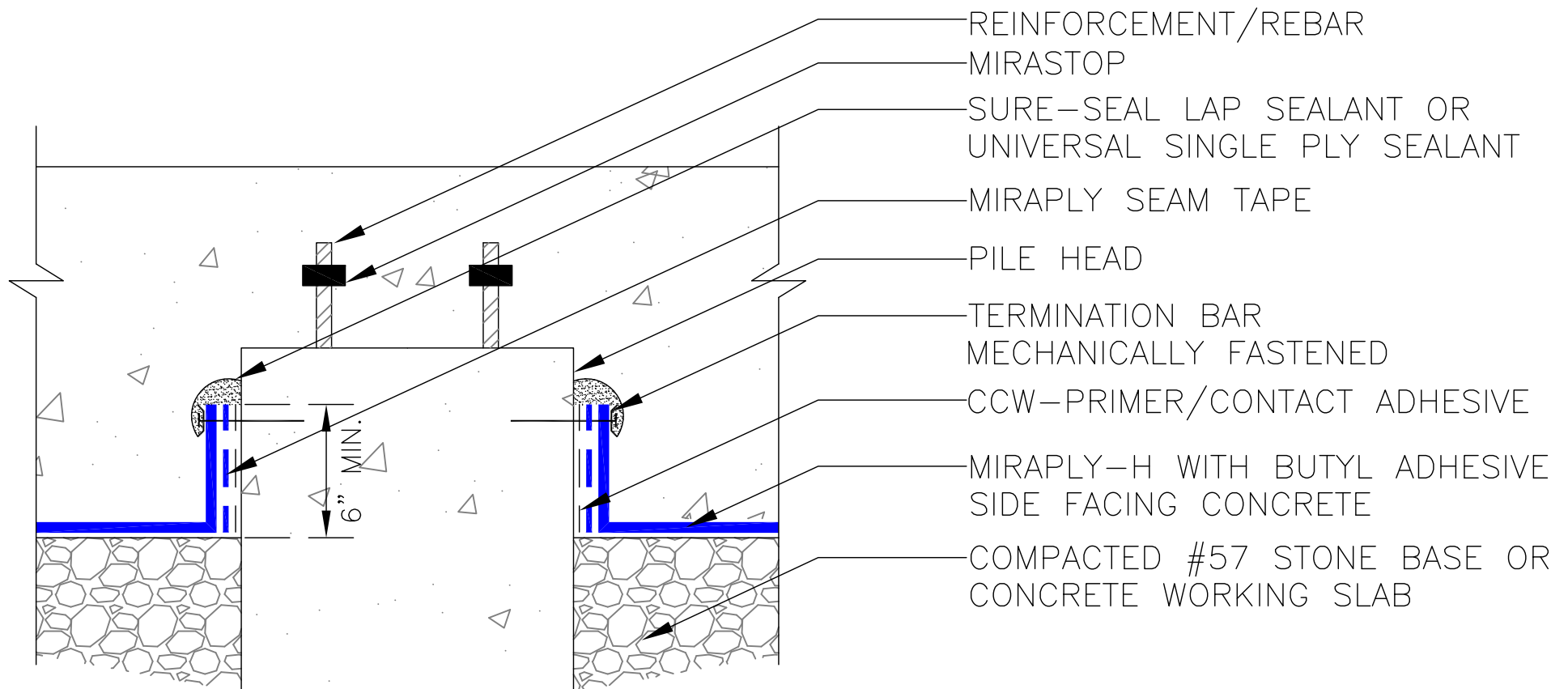

NOTES:

1. Concrete shall be smooth, sound and clean.
2. Refer to Technical Data Sheets for additional information.

DETAIL IS INTENDED TO BE A GUIDE FOR WATERPROOFING INSTALLATION ONLY.

MiraPLY™ BLINDSIDE WATERPROOFING

02/24/2020

N.T.S.

MP-20

PILE HEAD

CARLISLE
COATINGS & WATERPROOFING

© 2020 CARLISLE CORPORATION

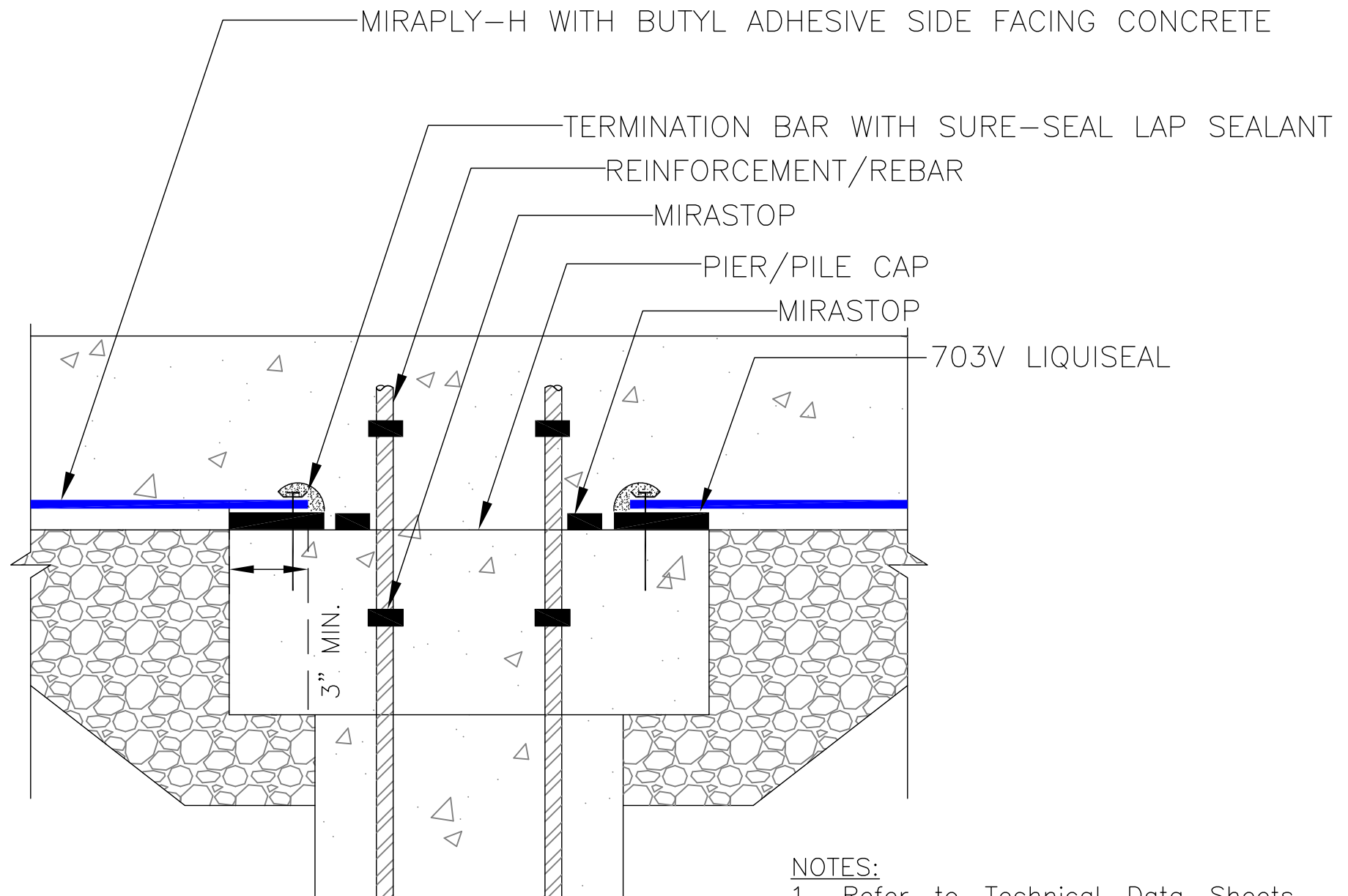

NOTES:

1. Refer to Technical Data Sheets for additional information.

DETAIL IS INTENDED TO BE A GUIDE FOR WATERPROOFING INSTALLATION ONLY.

MiraPLY™ BLINDSIDE WATERPROOFING

02/24/2020

N.T.S.

MP-21

MIRAPLY-H FLUSH PILE CAP

CARLISLE
COATINGS & WATERPROOFING

© 2020 CARLISLE CORPORATION

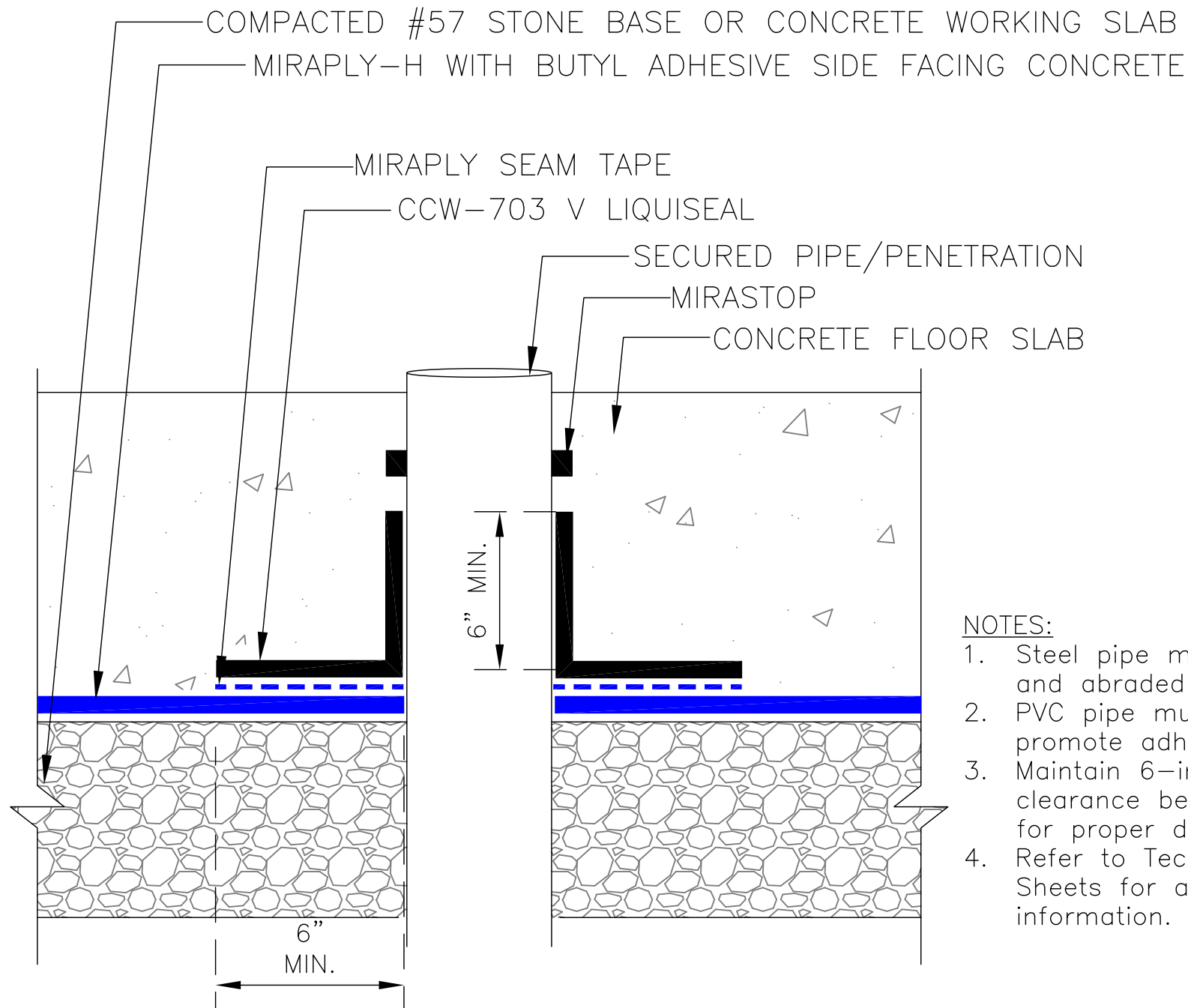

NOTES:

1. Steel pipe must be cleaned and abraded to bright finish.
2. PVC pipe must be abraded to promote adhesion.
3. Maintain 6-inches of clearance between penetrations for proper detailing.
4. Refer to Technical Data Sheets for additional information.

DETAIL IS INTENDED TO BE A GUIDE FOR WATERPROOFING INSTALLATION ONLY.

MiraPLY™ BLINDSIDE WATERPROOFING

02/24/2020

N.T.S.

MP-40

MIRAPLY-H PENETRATION

CARLISLE
COATINGS & WATERPROOFING

© 2020 CARLISLE CORPORATION

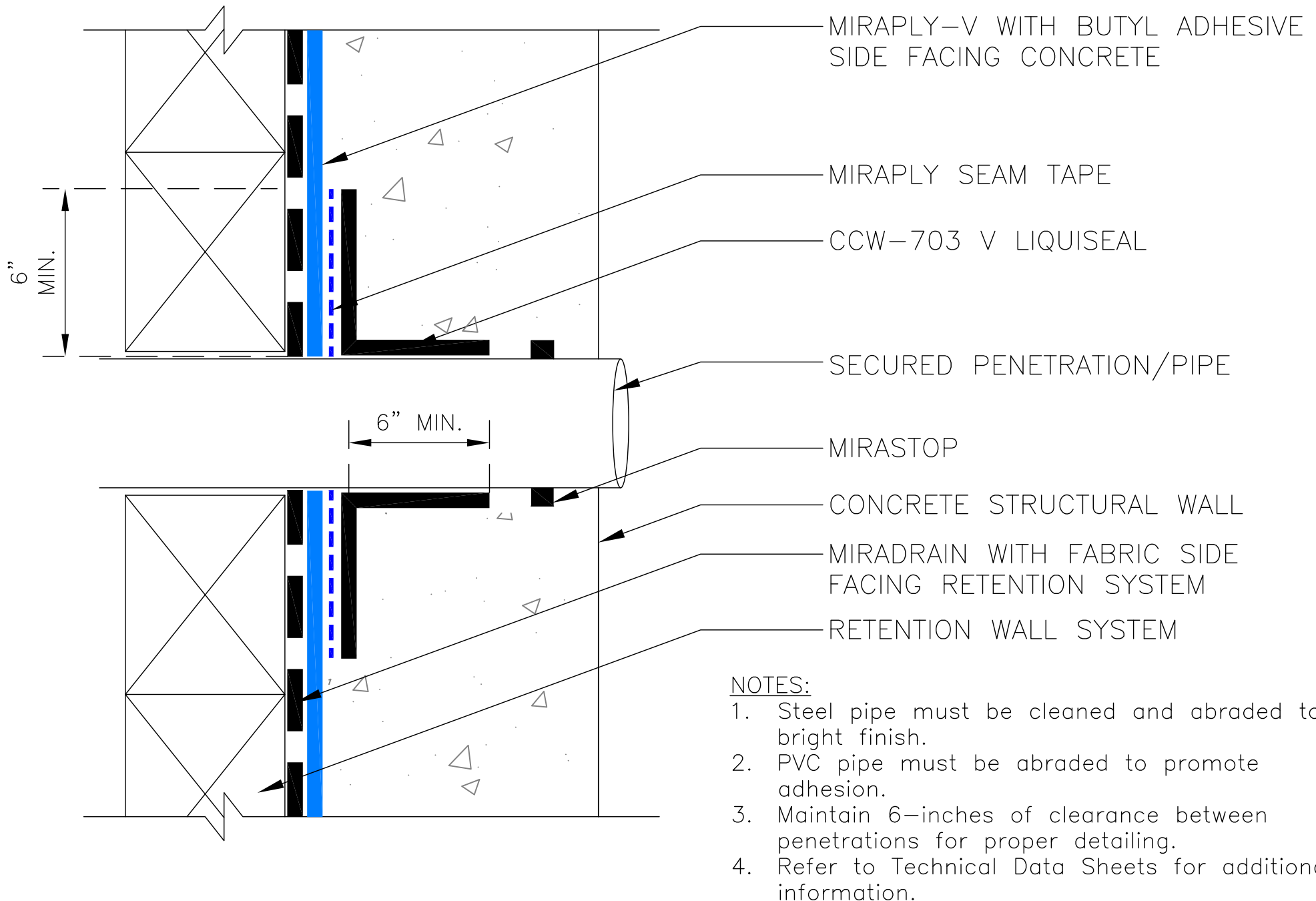

DETAIL IS INTENDED TO BE A GUIDE FOR
WATERPROOFING INSTALLATION ONLY.

MiraPLY™ BLINDSIDE WATERPROOFING

02/24/2020

N.T.S.

MP-41

MIRAPLY-V PENETRATION

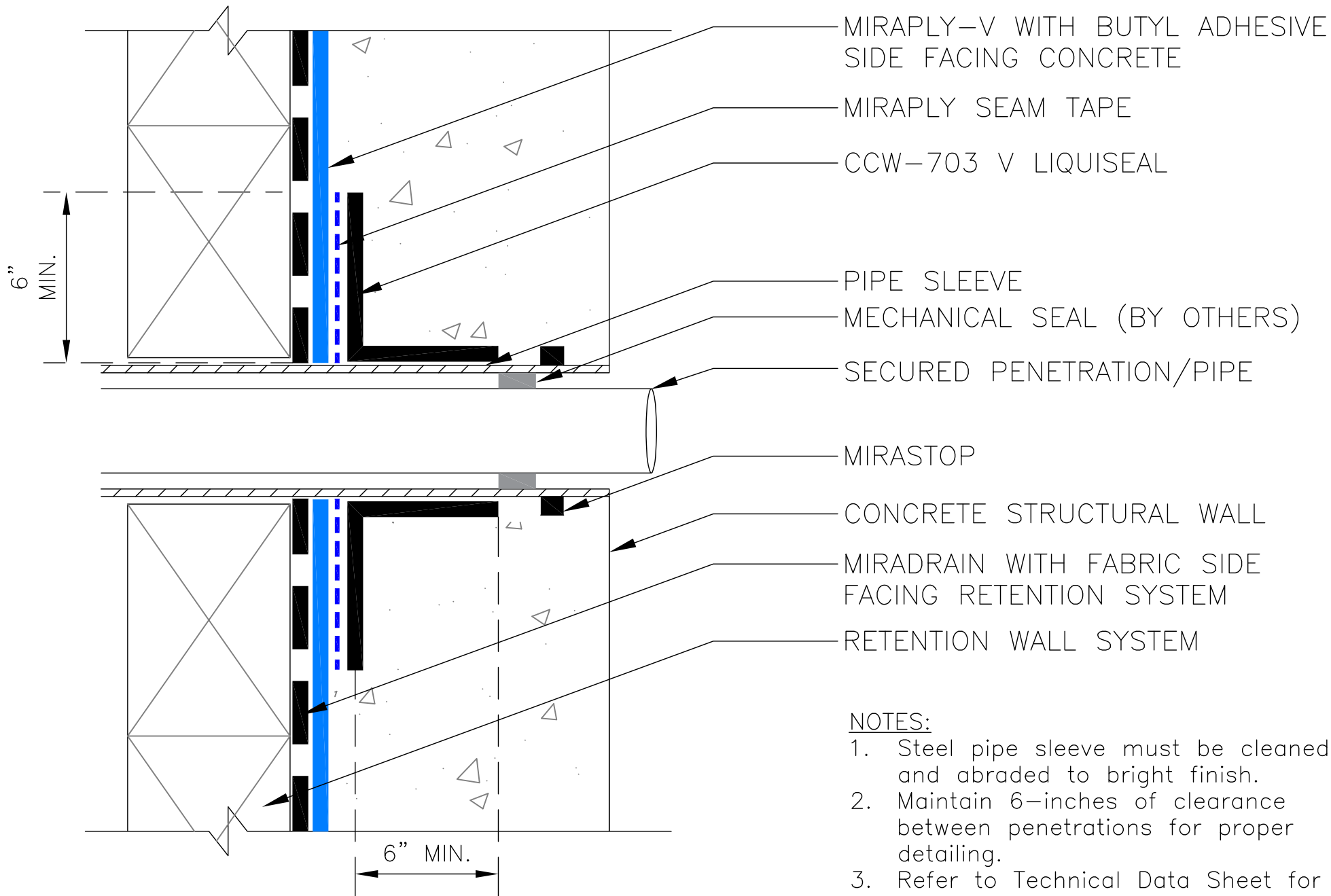

DETAIL IS INTENDED TO BE A GUIDE FOR
WATERPROOFING INSTALLATION ONLY.

MiraPLY™ BLINDSIDE WATERPROOFING

02/24/2020

N.T.S.

MP-42

MIRAPLY-V PIPE SLEEVE PENETRATION

CARLISLE
COATINGS & WATERPROOFING

© 2020 CARLISLE CORPORATION

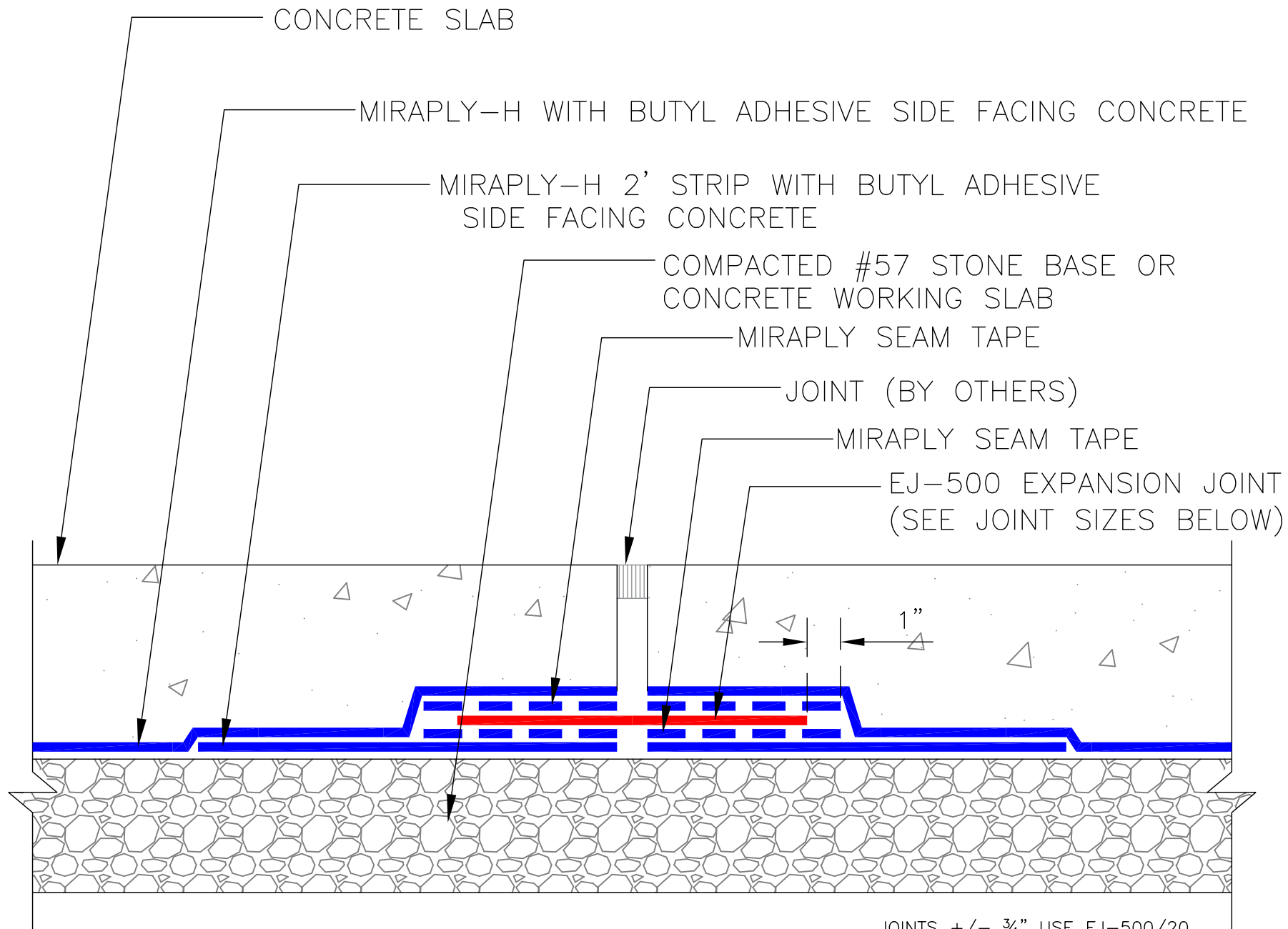

NOTES:

1. Refer to Technical Data Sheets for additional information.

JOINTS $\pm \frac{3}{4}$ " USE EJ-500/20
 JOINTS $\pm 1\frac{3}{4}$ " USE EJ-500/40
 JOINTS ± 2 " USE EJ-500/100

DETAIL IS INTENDED TO BE A GUIDE FOR
 WATERPROOFING INSTALLATION ONLY.

MiraPLY™ BLINDSIDE WATERPROOFING

02/24/2020

N.T.S.

MP-60

MIRAPLY-H SLAB EXPANSION JOINT

CARLISLE
 COATINGS & WATERPROOFING

© 2020 CARLISLE CORPORATION

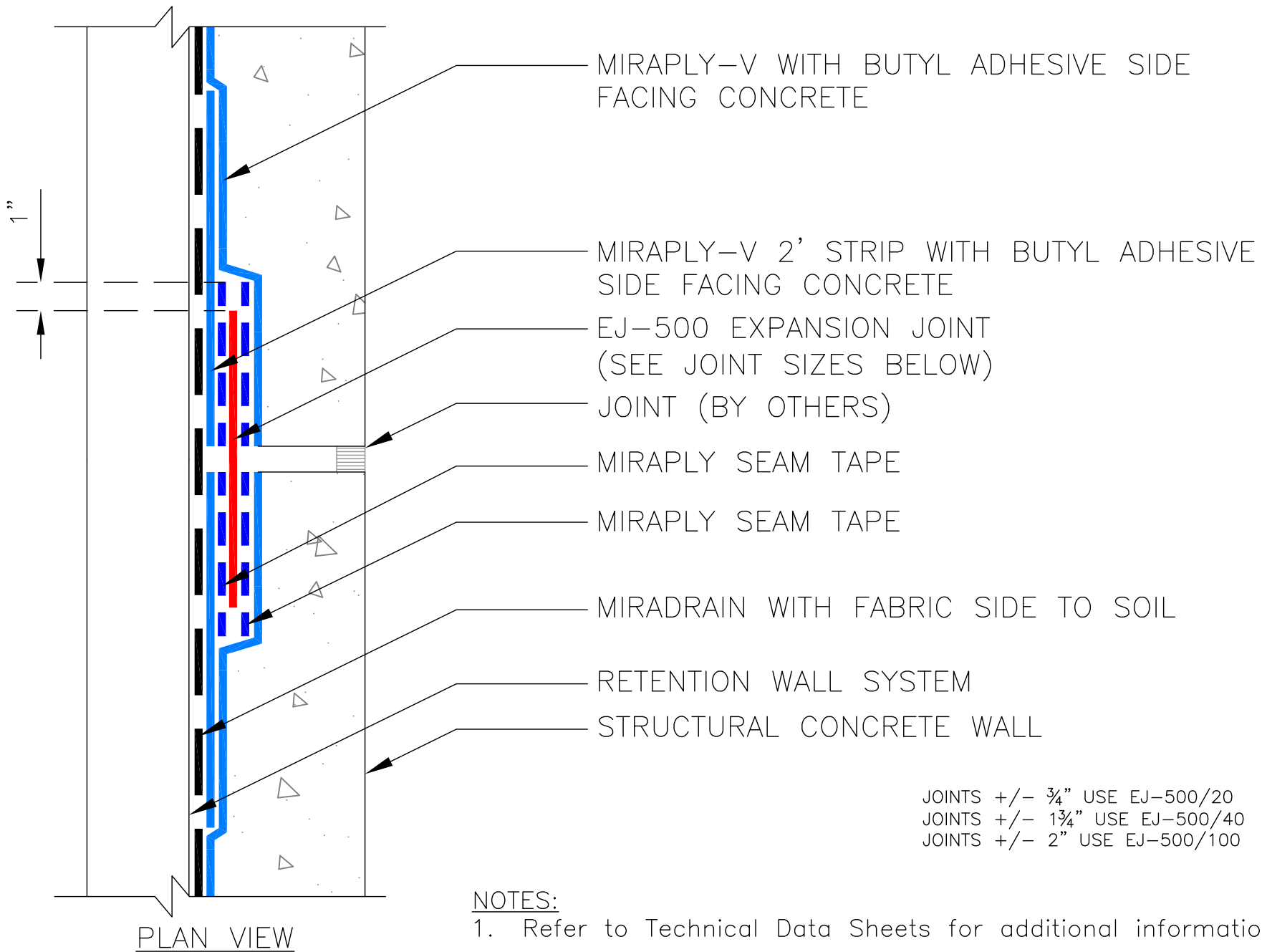

DETAIL IS INTENDED TO BE A GUIDE FOR WATERPROOFING INSTALLATION ONLY.

MiraPLY™ BLINDSIDE WATERPROOFING

02/24/2020

N.T.S.

MP-61

MIRAPLY-V WALL EXPANSION JOINT

CARLISLE
COATINGS & WATERPROOFING

© 2020 CARLISLE CORPORATION

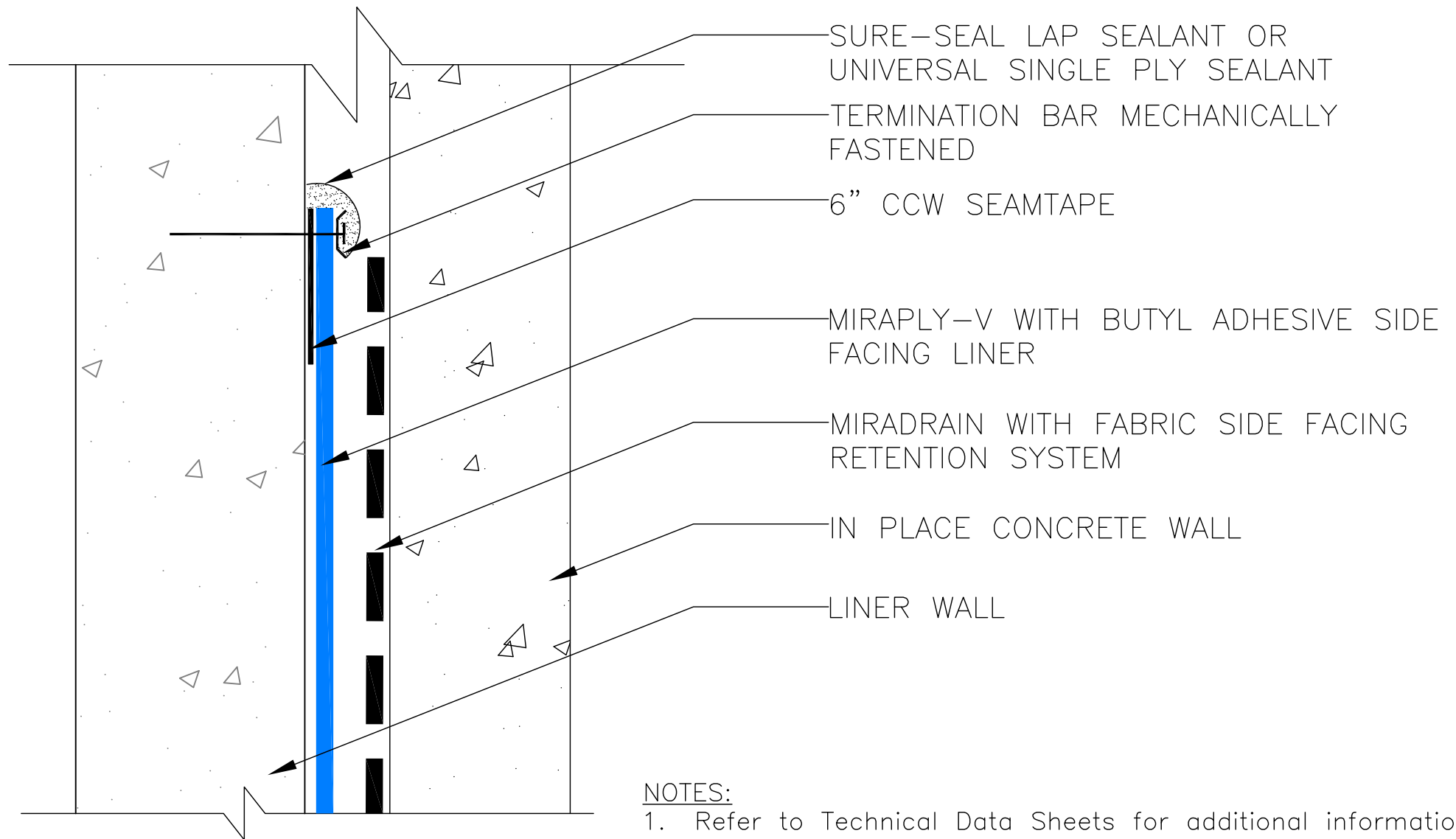

DETAIL IS INTENDED TO BE A GUIDE FOR
WATERPROOFING INSTALLATION ONLY.

MiraPLY™ BLINDSIDE WATERPROOFING

02/24/2020

N.T.S.

MP-70

BELOW GRADE TERMINATION

CARLISLE
COATINGS & WATERPROOFING
© 2020 CARLISLE CORPORATION

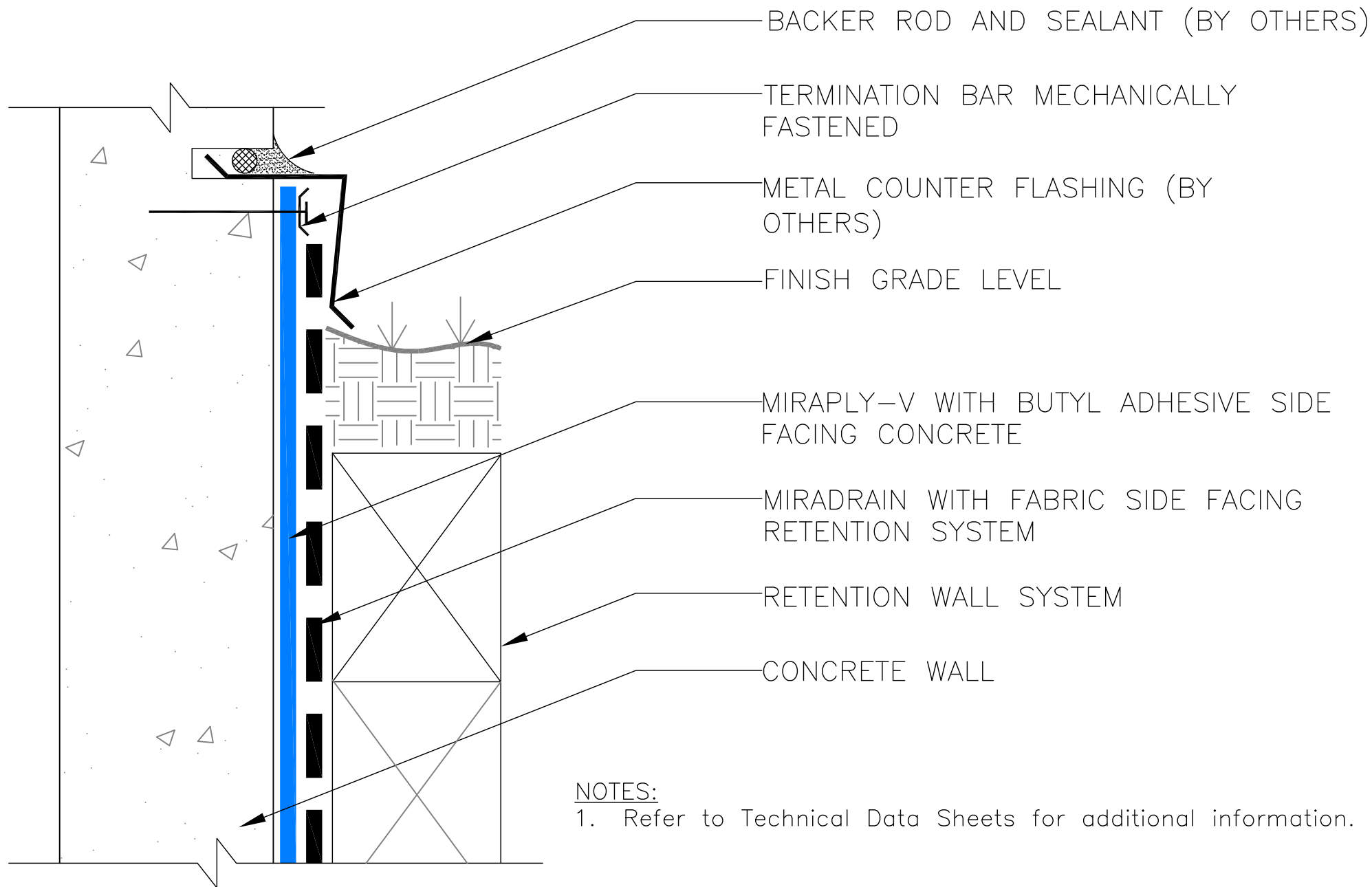

DETAIL IS INTENDED TO BE A GUIDE FOR WATERPROOFING INSTALLATION ONLY.

MiraPLY™ BLINDSIDE WATERPROOFING

02/24/2020

N.T.S.

MP-71

EXPOSED TERMINATION

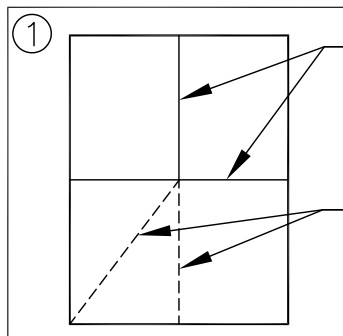

① FOLD CCW—MIRAPLY
6" MIN IN ALL DIRECTIONS
AND CREASE W/ ROLLER

CUT OUT MIRAPLY
AT 45 DEG ANGLE

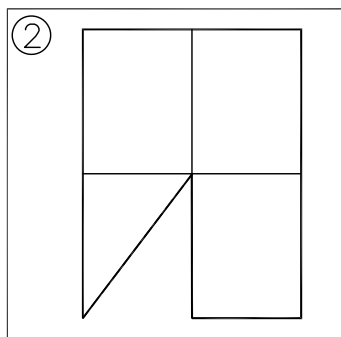

②

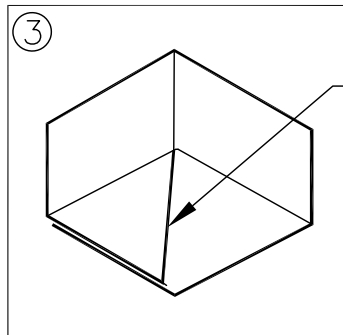

③

REMOVE RELEASE LINER
FROM MIRAPLY AND HAND
ROLL 45 DEG FLAP DOWN
ONTO BOTTOM PIECE

④

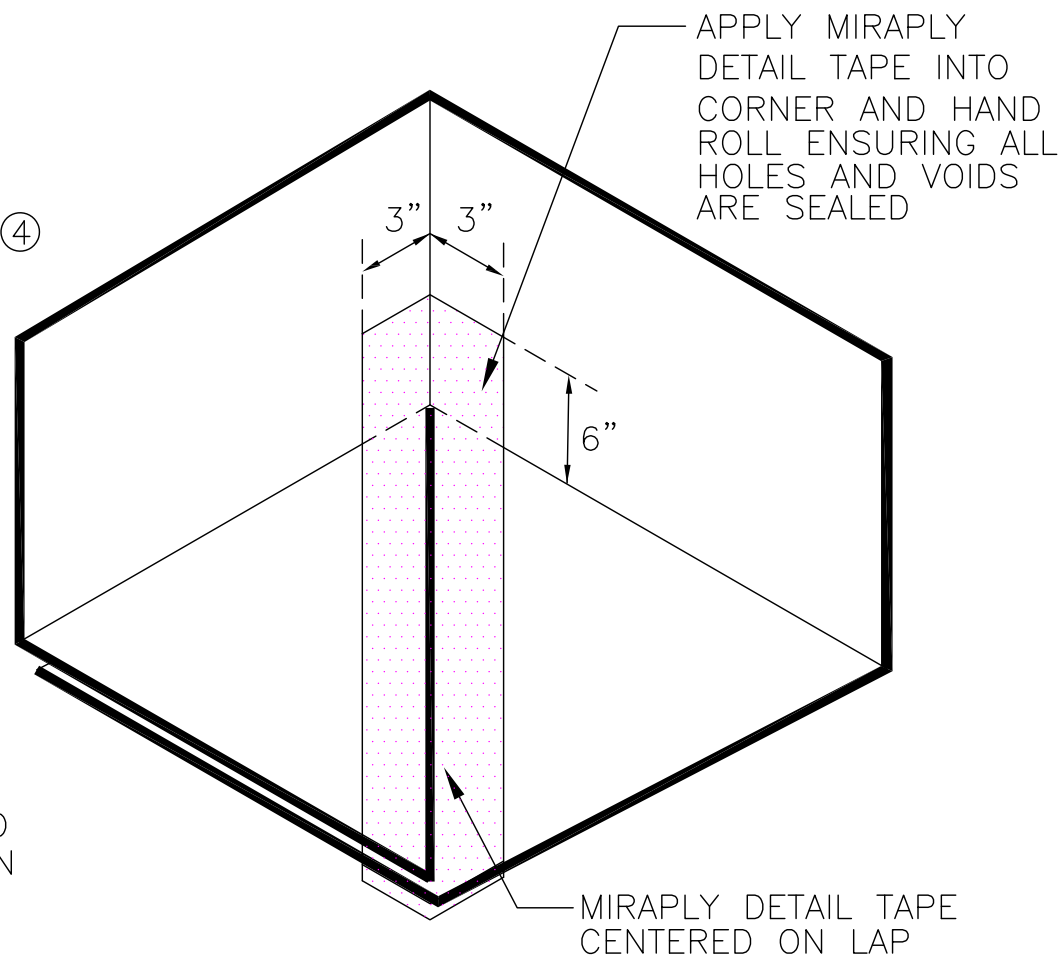

NOTES:

1. Refer to Technical Data Sheets for additional information.

DETAIL IS INTENDED TO BE A GUIDE FOR
WATERPROOFING INSTALLATION ONLY.

MiraPLY™ BLINDSIDE WATERPROOFING

02/24/2020

N.T.S.

MP-80

MIRAPLY INSIDE CORNER

CARLISLE
COATINGS & WATERPROOFING

© 2020 CARLISLE CORPORATION

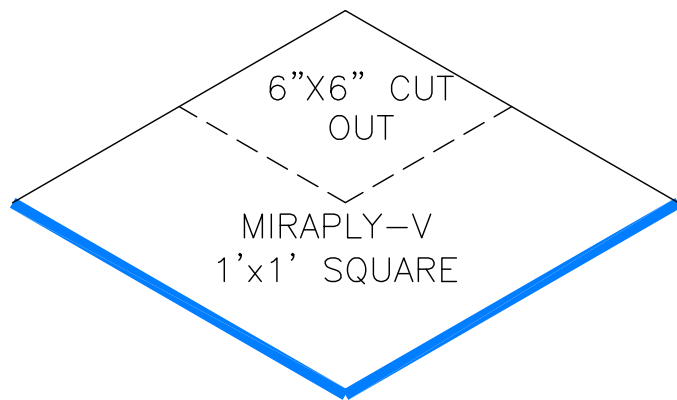

- ① CUT OUT 1'X1' SQUARE OF MIRAPLY-V AND THEN A 6"X6" SQUARE NOTCH TO CREATE A 90 DEGREE FLAT ANGLE SHEET

②

MAKE A STRAIGHT LINE RELIEF CUT AT THE OUTSIDE CORNER OF A MIRAPLY-V SHEET WITH THE MIRAPLY-V EXTENDING ONTO THE HORIZONTAL 6"-9"

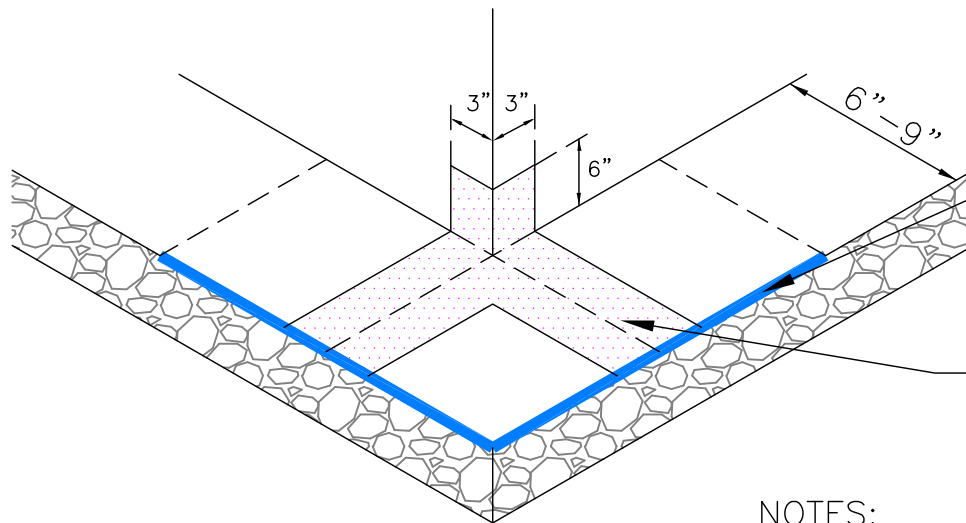
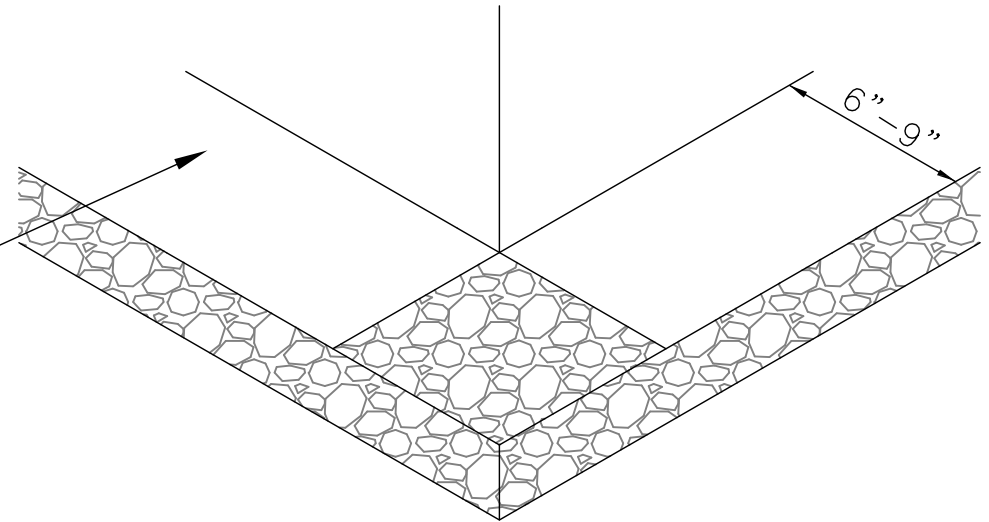

③

REMOVE RELEASE LINER FROM 90 DEGREE FLAT ANGLE SHEET AND INSTALL UNDER OUTSIDE CORNER RELIEF CUT AT HORIZONTAL

④

INSTALL MIRAPLY DETAIL TAPE TO CUT EDGES AND HAND ROLL ENSURING ALL HOLES AND VOIDS ARE SEALED

NOTES:

1. Refer to Technical Data Sheets for additional information.

DETAIL IS INTENDED TO BE A GUIDE FOR WATERPROOFING INSTALLATION ONLY.

MiraPLY™ BLINDSIDE WATERPROOFING

02/24/2020

N.T.S.

MP-81

MIRAPLY OUTSIDE CORNER

CARLISLE
COATINGS & WATERPROOFING

© 2020 CARLISLE CORPORATION

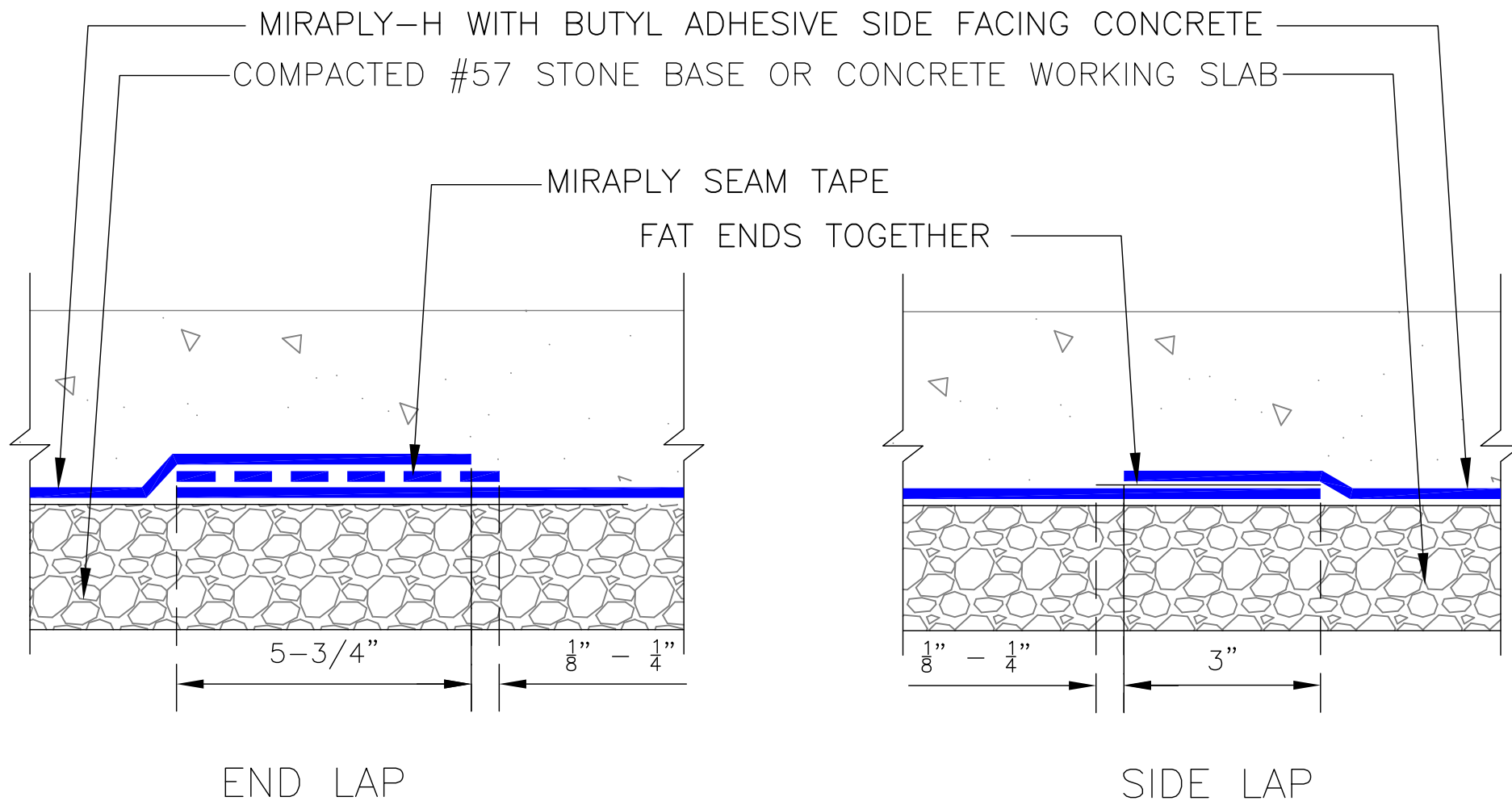

NOTES:

1. For Side Laps, install sheets of MiraPLY-H with a minimum 3" side overlap with 1" - 1/4" of exposed adhesive. Ensure the membrane lays flat and no openings are visible. Stagger end laps. Remove the release liners on the Miraply Seam Tape, for end lap, and Factory Applied Tape (FAT) mating the two sheets together. After the seam is fully constructed, roll the seam with a hard rubber roller.
2. Refer to Detail Drawing MP-91 to seal "T" Joints.
3. Refer to Technical Data Sheets for additional information.

DETAIL IS INTENDED TO BE A GUIDE FOR
WATERPROOFING INSTALLATION ONLY.

MiraPLY™ BLINDSIDE WATERPROOFING

MIRAPLY-H END AND SIDE LAP

02/24/2020

N.T.S.

MP-90

CARLISLE
COATINGS & WATERPROOFING

© 2020 CARLISLE CORPORATION

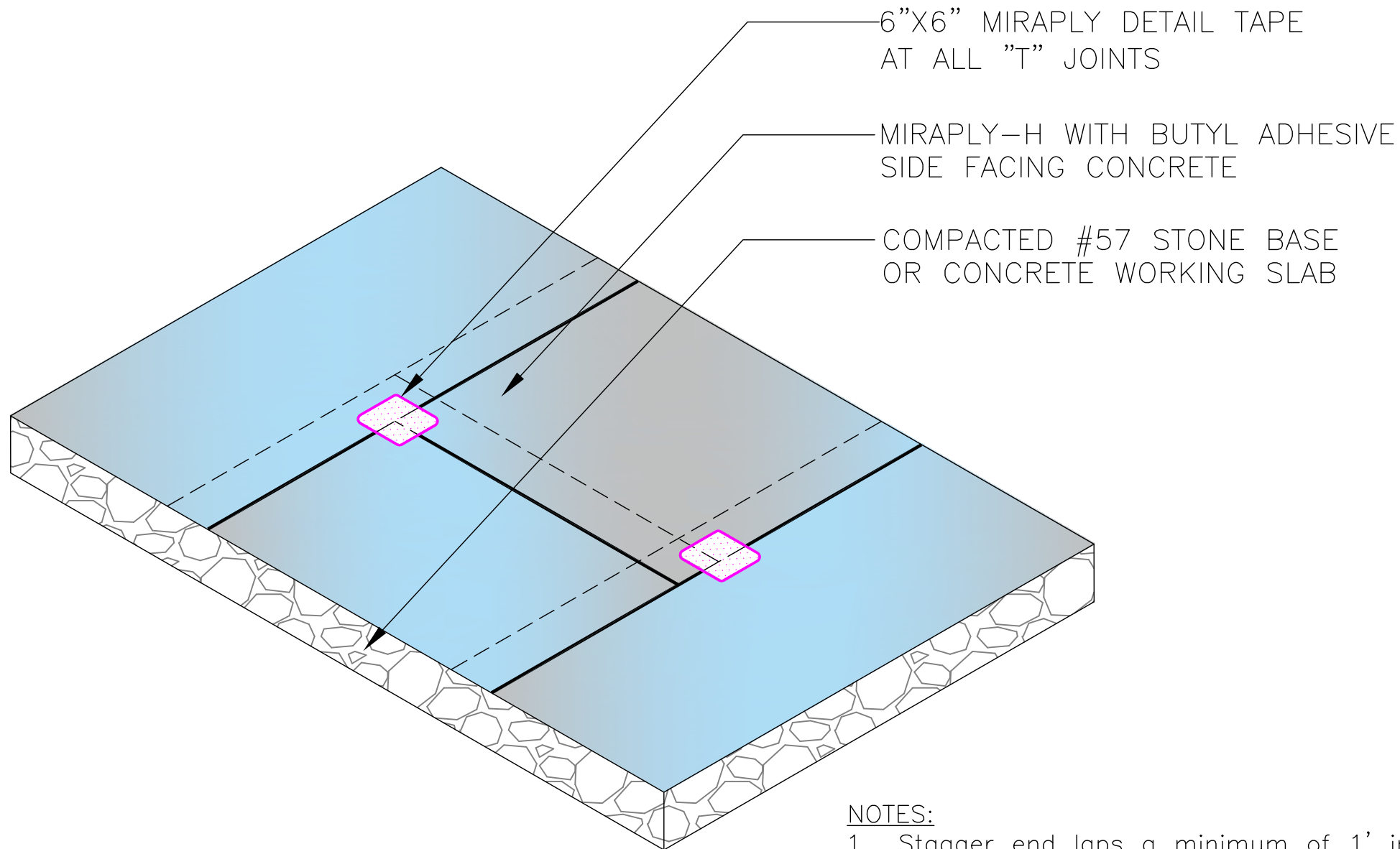

NOTES:

1. Stagger end laps a minimum of 1' in open field areas.
2. Refer to Technical Data Sheets for additional information.

DETAIL IS INTENDED TO BE A GUIDE FOR
WATERPROOFING INSTALLATION ONLY.

MiraPLY™ BLINDSIDE WATERPROOFING

02/24/2020

N.T.S.

MP-91

MIRAPLY-H "T" JOINTS

CARLISLE
COATINGS & WATERPROOFING

© 2020 CARLISLE CORPORATION

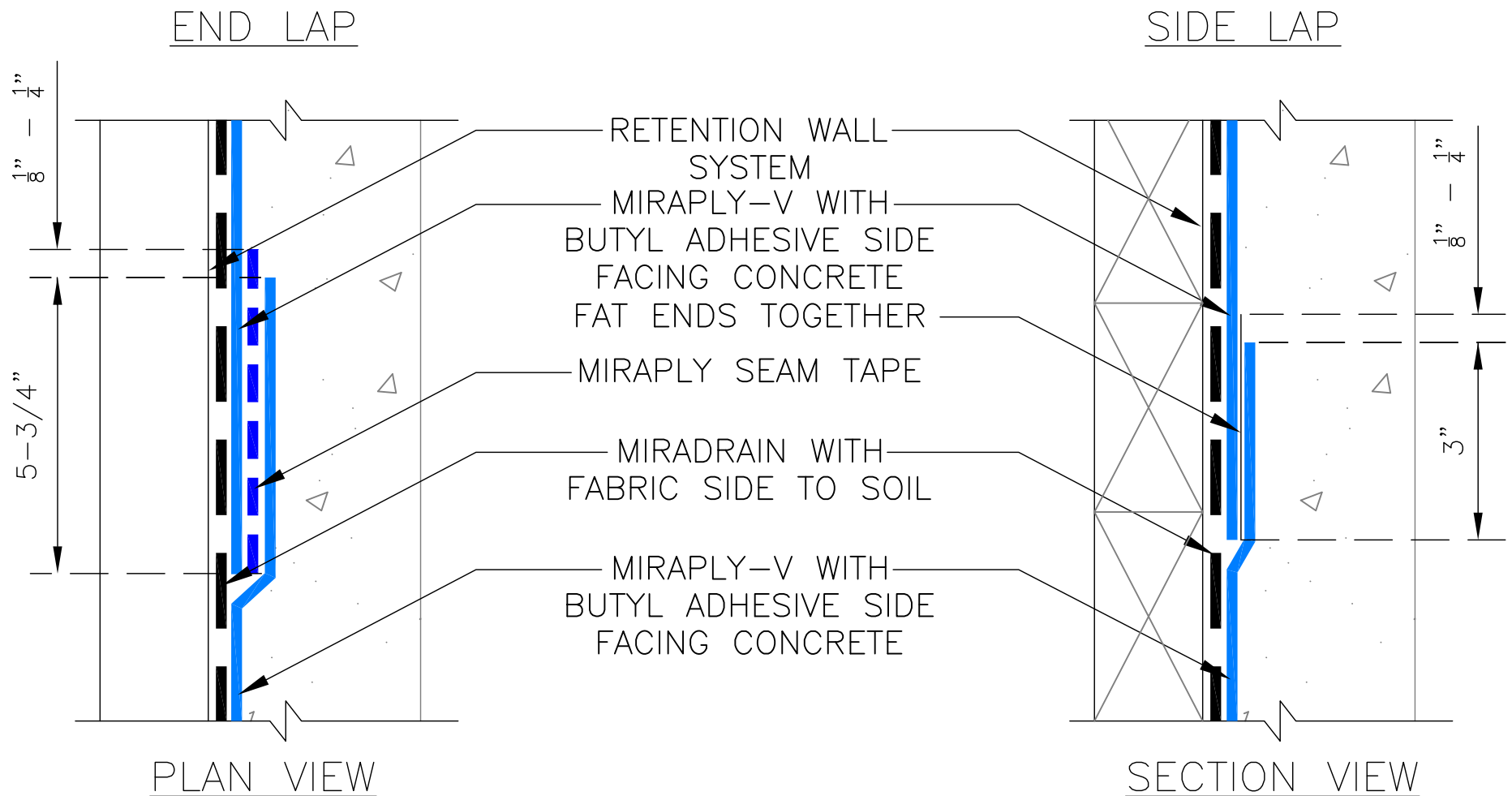

NOTES:

1. For Side Laps, install sheets of MiraPLY-V with a minimum 3" side overlap with 1" - 1/4" of exposed adhesive. Ensure the membrane lays flat and no openings are visible. Stagger end laps. Remove the release liners on the Miraply Seam Tape, for end lap, and Factory Applied Tape (FAT) mating the two sheets together. After the seam is fully constructed, roll the seam with a hard rubber roller.
2. Refer to Detail Drawing MP-93 to seal "T" Joints.
3. Refer to Technical Data Sheets for additional information.

DETAIL IS INTENDED TO BE A GUIDE FOR WATERPROOFING INSTALLATION ONLY.

MiraPLY™ BLINDSIDE WATERPROOFING

02/24/2020

N.T.S.

MP-92

MIRAPLY-V END AND SIDE LAP

CARLISLE
COATINGS & WATERPROOFING

© 2020 CARLISLE CORPORATION

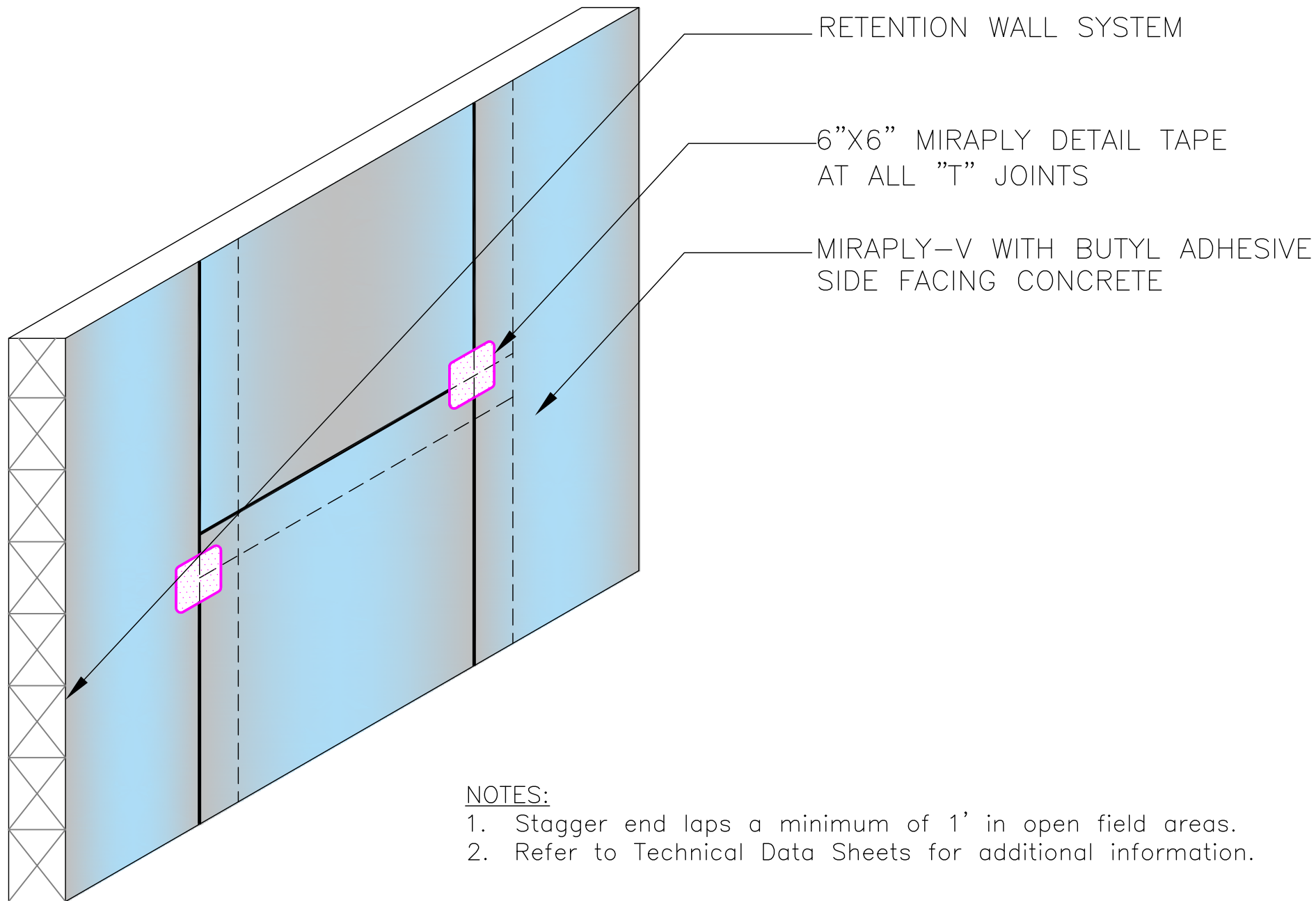

DETAIL IS INTENDED TO BE A GUIDE FOR WATERPROOFING INSTALLATION ONLY.

MiraPLY™ BLINDSIDE WATERPROOFING

02/24/2020

N.T.S.

MP-93

MIRAPLY-V "T" JOINTS

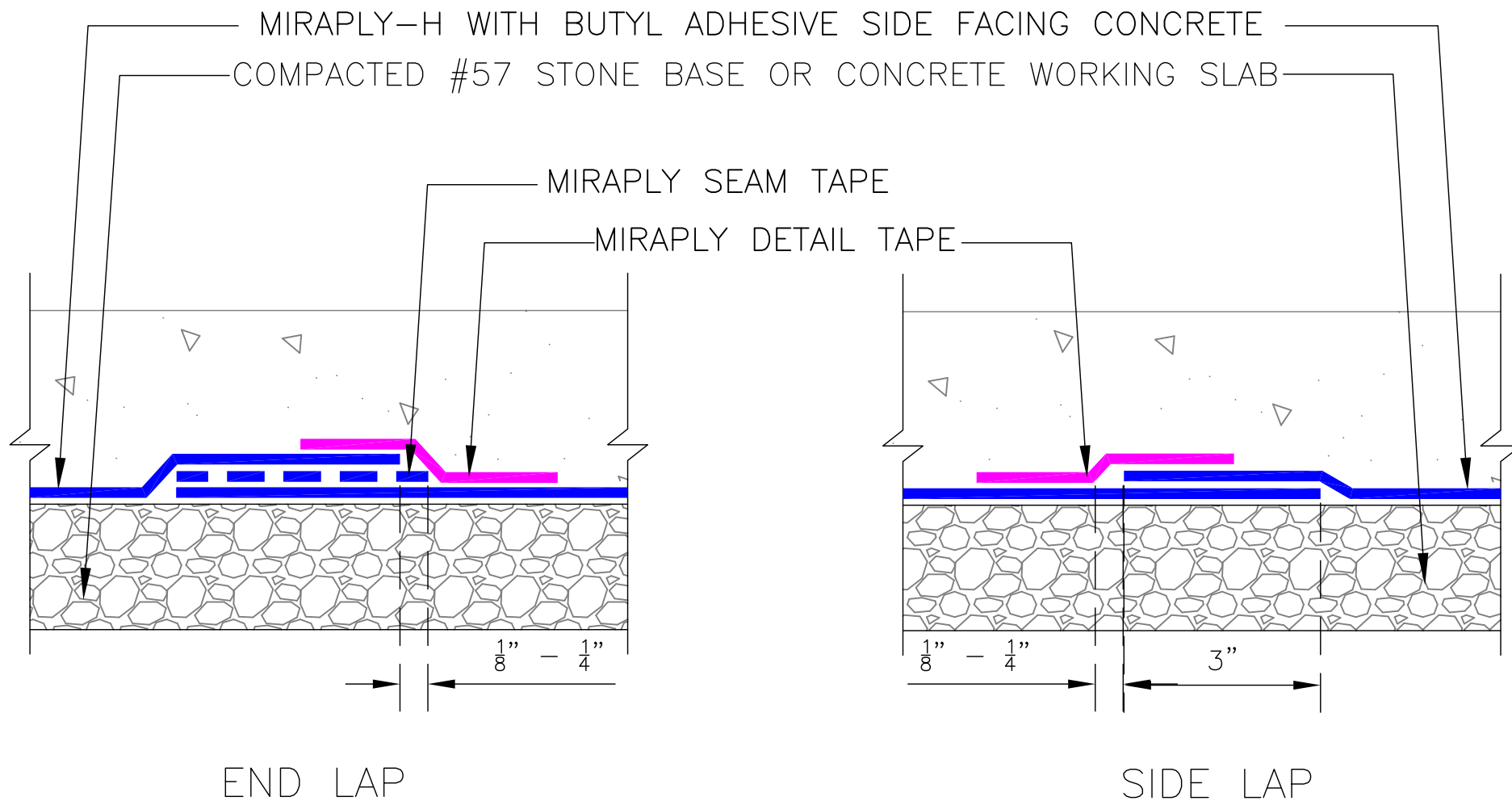

NOTES:

1. For Side Laps, install sheets of MiraPLY-H with a minimum 3" side overlap with 1" - 1/4" of exposed adhesive. Ensure the membrane lays flat and no openings are visible. Stagger end laps. Remove the release liners on the Miraply Seam Tape, for end lap, and Factory Applied Tape (FAT) mating the two sheets together. After the seam is fully constructed, roll the seam with a hard rubber roller.
2. Refer to Technical Data Sheets for additional information.

DETAIL IS INTENDED TO BE A GUIDE FOR
WATERPROOFING INSTALLATION ONLY.

MiraPLY™ BLINDSIDE WATERPROOFING

02/24/2020

N.T.S.

MP-94

ENHANCED MIRAPLY-H
END AND SIDE LAP

CARLISLE
COATINGS & WATERPROOFING

© 2020 CARLISLE CORPORATION

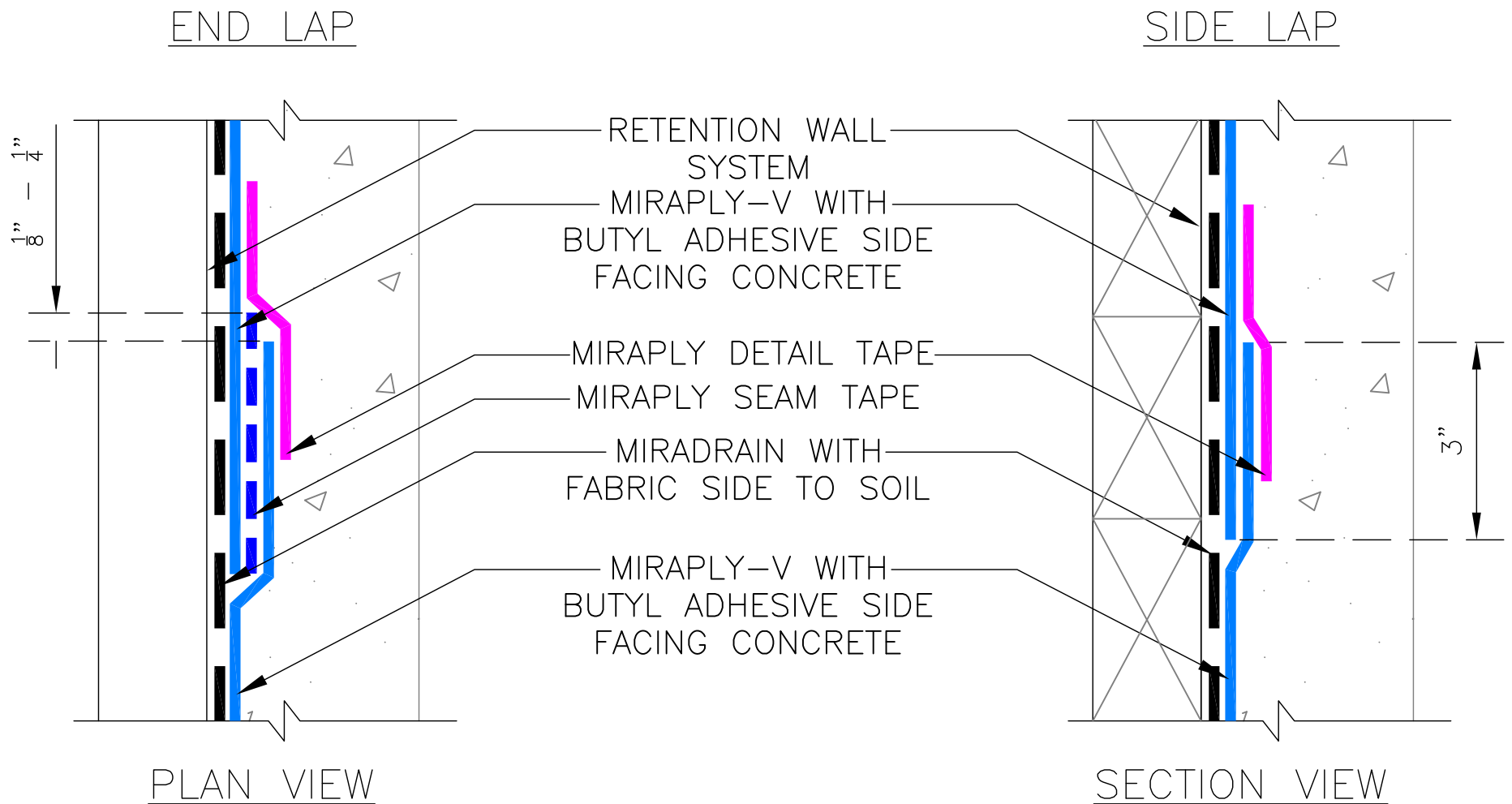

NOTES:

1. For Side Laps, install sheets of MiraPLY-V with a minimum 3" side overlap with $\frac{1}{8}$ " - $\frac{1}{4}$ " of exposed adhesive. Ensure the membrane lays flat and no openings are visible. Stagger end laps. Remove the release liners on the Miraply Seam Tape, for end lap, and Factory Applied Tape (FAT) mating the two sheets together. After the seam is fully constructed, roll the seam with a hard rubber roller.
2. For shotcrete application, the shotcrete company must be a licensed company and the nozzleman must be ACI Certified.
3. Refer to Technical Data Sheets for additional information.

DETAIL IS INTENDED TO BE A GUIDE FOR
WATERPROOFING INSTALLATION ONLY.

MiraPLY™ BLINDSIDE WATERPROOFING

02/24/2020

N.T.S.

MP-95

ENHANCED MIRAPLY-V END
AND SIDE LAP

CARLISLE
COATINGS & WATERPROOFING

© 2020 CARLISLE CORPORATION

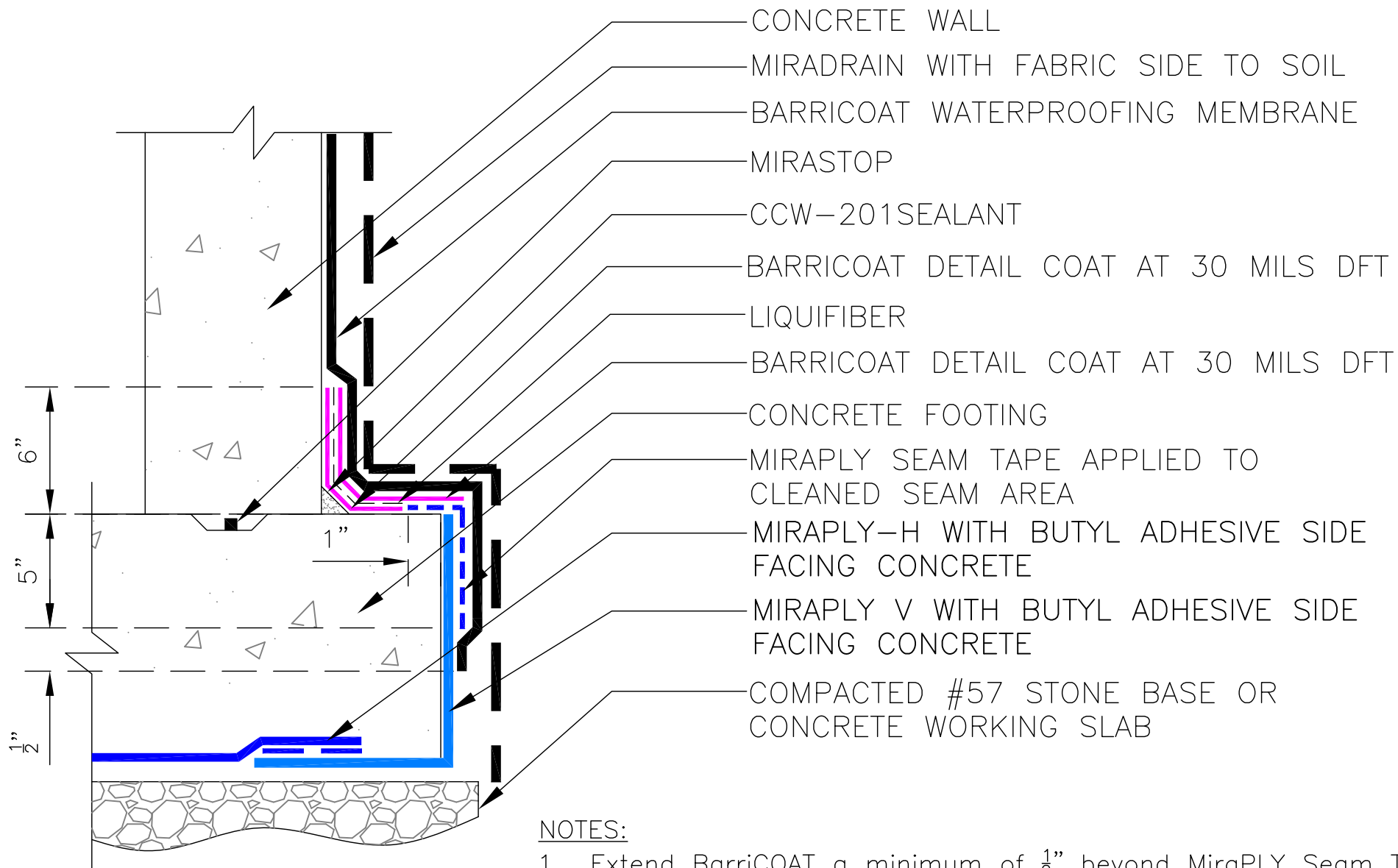

NOTES:

1. Extend BarriCOAT a minimum of $\frac{1}{2}$ " beyond MiraPLY Seam Tape.
2. CCW-MiraDRAIN HC or CCW approved perimeter drain not shown for clarity.
3. Refer to Technical Data Sheets for additional information.

DETAIL IS INTENDED TO BE A GUIDE FOR WATERPROOFING INSTALLATION ONLY.

MiraPLY™ BLINDSIDE WATERPROOFING

02/24/2020

N.T.S.

MP-100

MIRAPLY-H TO BARRICOAT
AT FOOTING TIE-IN

CARLISLE
COATINGS & WATERPROOFING
© 2020 CARLISLE CORPORATION

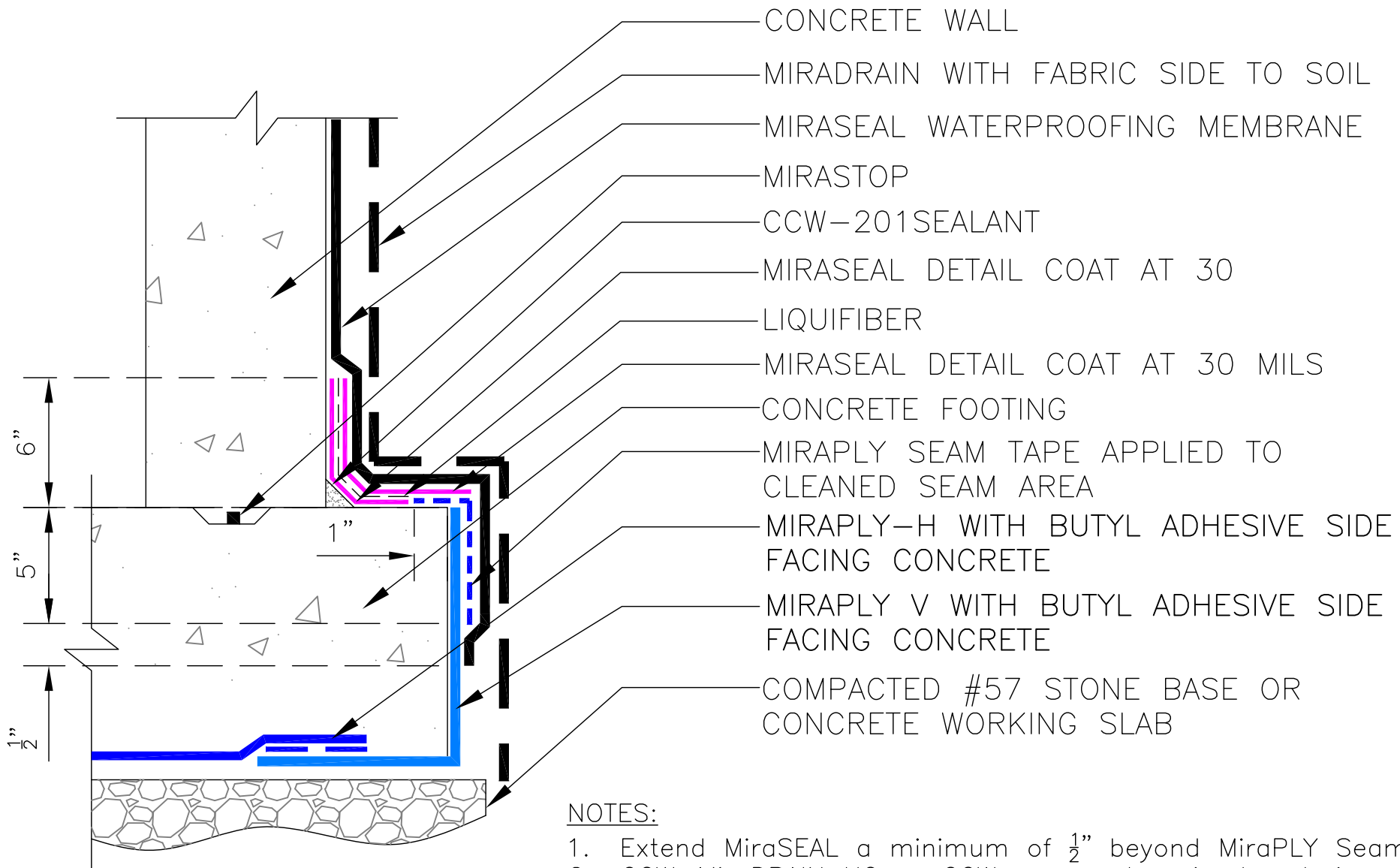

NOTES:

1. Extend MiraSEAL a minimum of $\frac{1}{2}$ " beyond MiraPLY Seam Tape.
2. CCW-MiraDRAIN HC or CCW approved perimeter drain not shown for clarity.
3. Refer to Technical Data Sheets for additional information.

DETAIL IS INTENDED TO BE A GUIDE FOR WATERPROOFING INSTALLATION ONLY.

MiraPLY™ BLINDSIDE WATERPROOFING

02/24/2020

N.T.S.

MP-104

MIRAPLY-H TO MIRASEAL
AT FOOTING TIE-IN

CARLISLE
COATINGS & WATERPROOFING
© 2020 CARLISLE CORPORATION

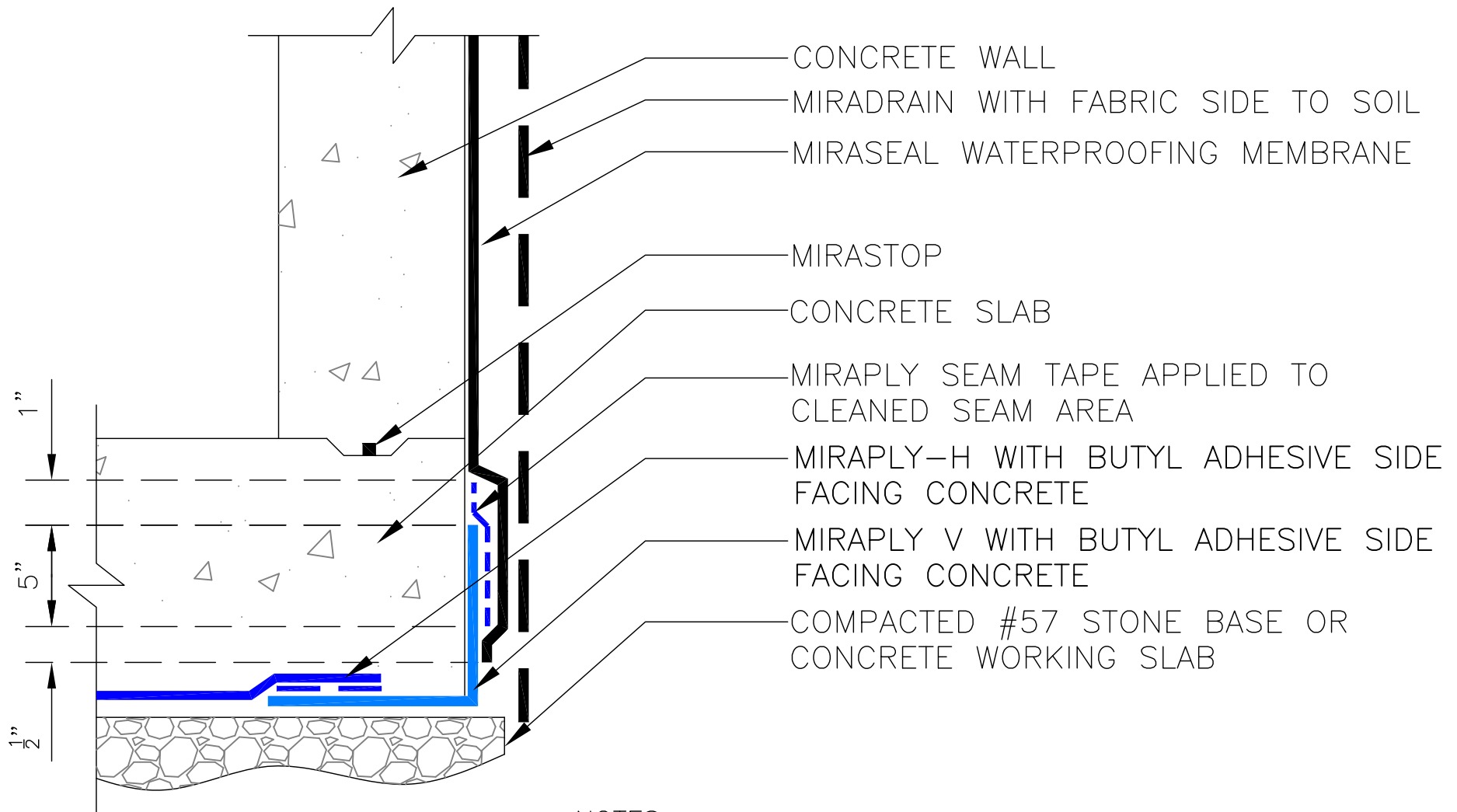

NOTES:

1. Extend MiraSEAL a minimum of $\frac{1}{2}$ " beyond MiraPLY Seam Tape.
2. Refer to Technical Data Sheets for additional information.

DETAIL IS INTENDED TO BE A GUIDE FOR WATERPROOFING INSTALLATION ONLY.

MiraPLY™ BLINDSIDE WATERPROOFING

02/24/2020

N.T.S.

MP-105

MIRAPLY-H TO MIRASEAL
AT SLAB TIE-IN

CARLISLE
COATINGS & WATERPROOFING

© 2020 CARLISLE CORPORATION

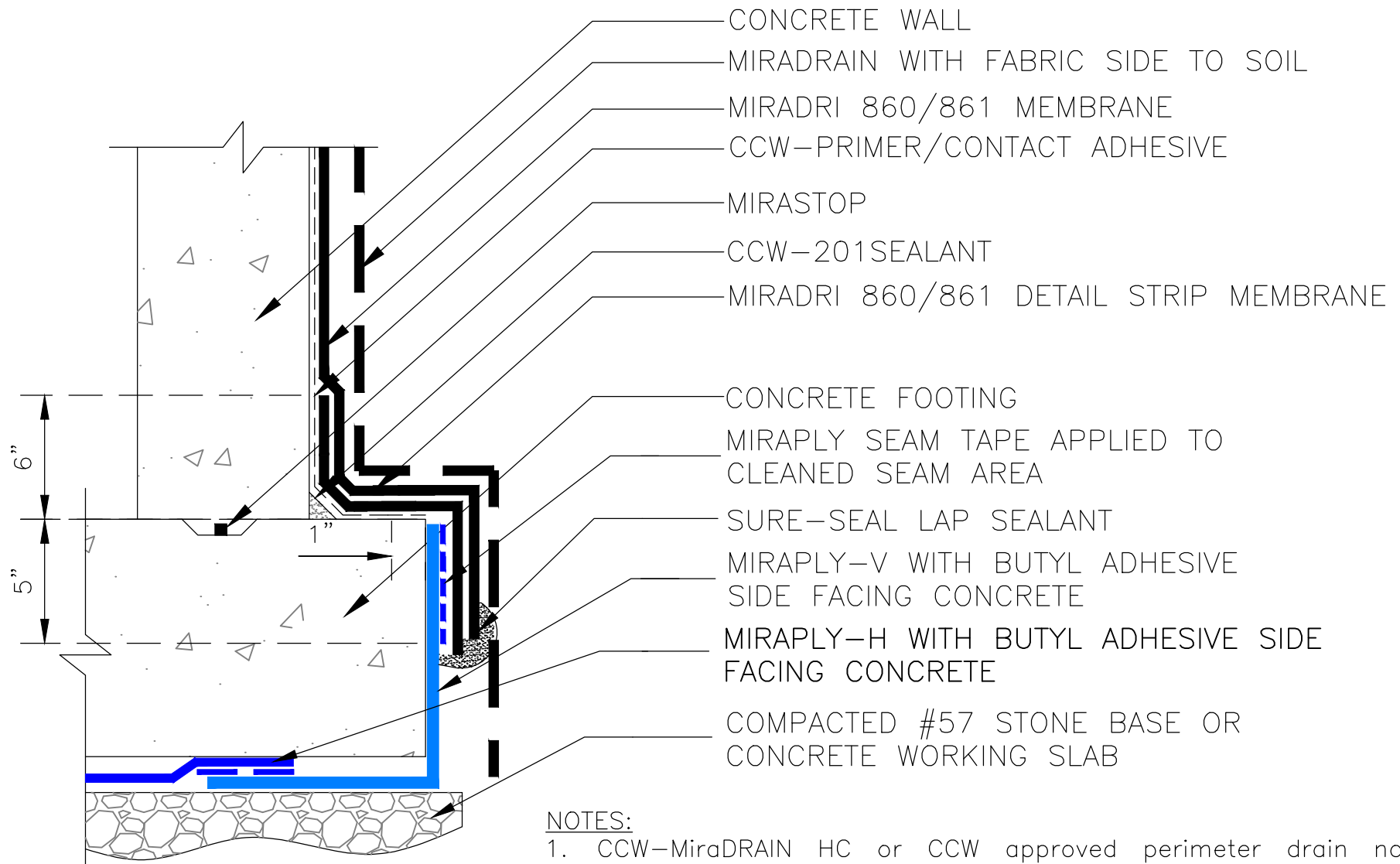

NOTES:

1. CCW-MiraDRAIN HC or CCW approved perimeter drain not shown for clarity.
2. Refer to Technical Data Sheets for additional information.

DETAIL IS INTENDED TO BE A GUIDE FOR WATERPROOFING INSTALLATION ONLY.

09/24/2021

N.T.S.

MP-106

MiraPLY™ BLINDSIDE WATERPROOFING

MIRAPLY-H TO MIRADRI 860
AT FOOTING TIE-IN



© 2021 CARLISLE CORPORATION

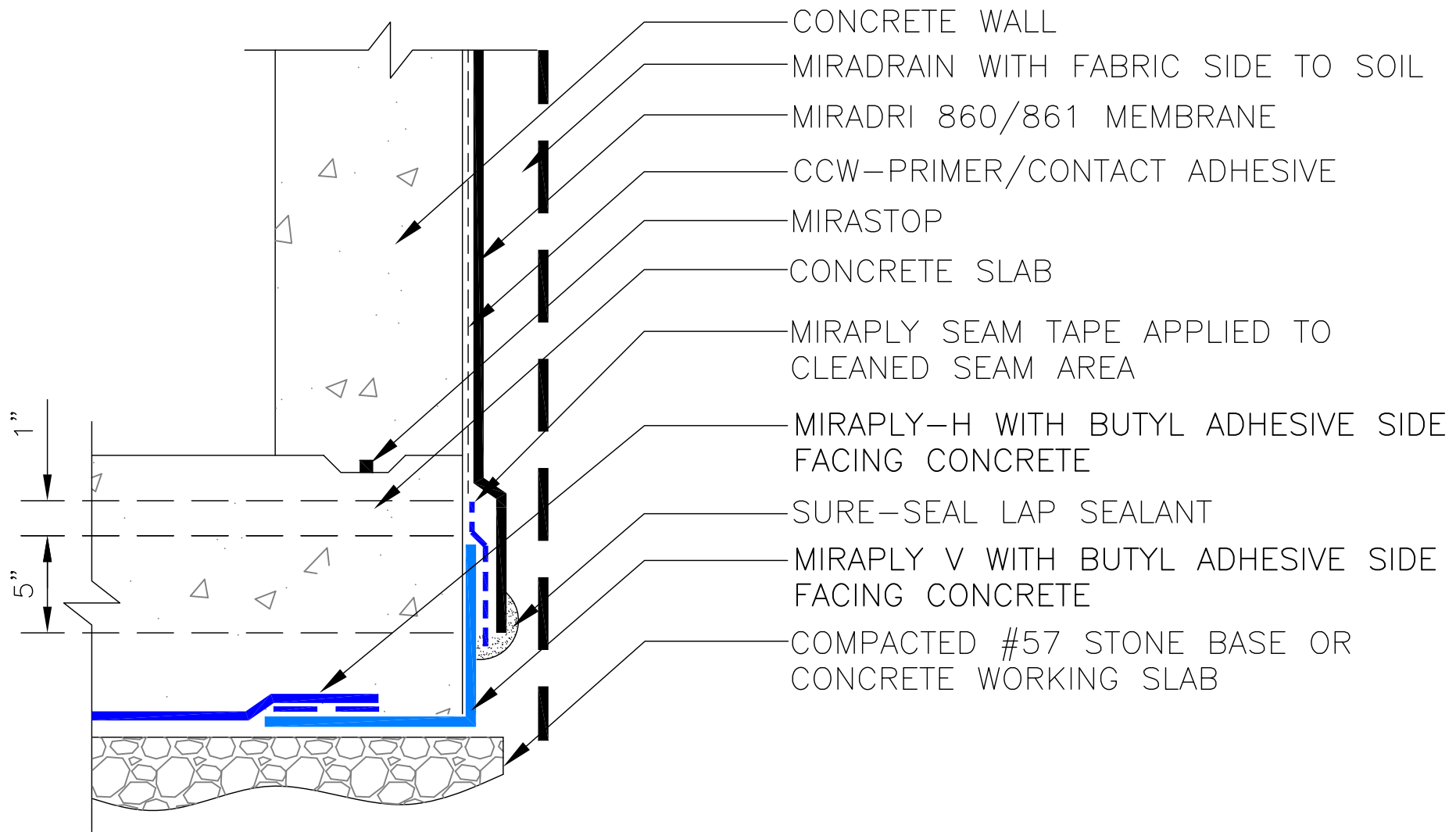

NOTES:

1. Refer to Technical Data Sheets for additional information.

DETAIL IS INTENDED TO BE A GUIDE FOR WATERPROOFING INSTALLATION ONLY.

MiraPLY™ BLINDSIDE WATERPROOFING

02/24/2020

N.T.S.

MP-107

MIRAPLY-H TO
MIRADRI AT SLAB TIE-IN

CARLISLE
COATINGS & WATERPROOFING

© 2020 CARLISLE CORPORATION

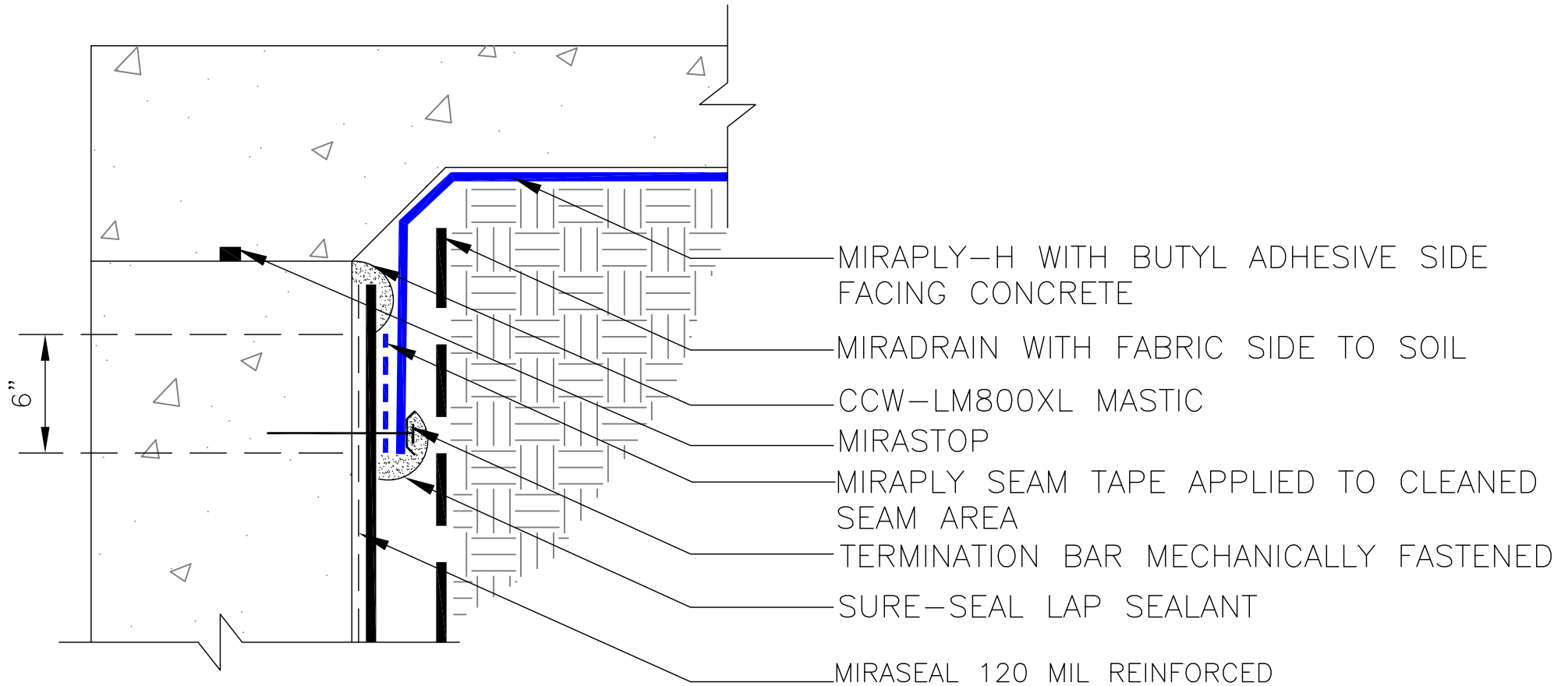

NOTES:

1. Refer to Technical Data Sheets for additional information.

DETAIL IS INTENDED TO BE A GUIDE FOR
WATERPROOFING INSTALLATION ONLY.

MiraPLY™ BLINDSIDE WATERPROOFING

02/24/2020 | N.T.S.

MIRAPLY-H TO MIRASEAL
AT VERTICAL WALL

MP-108

CARLISLE
COATINGS & WATERPROOFING

© 2020 CARLISLE CORPORATION

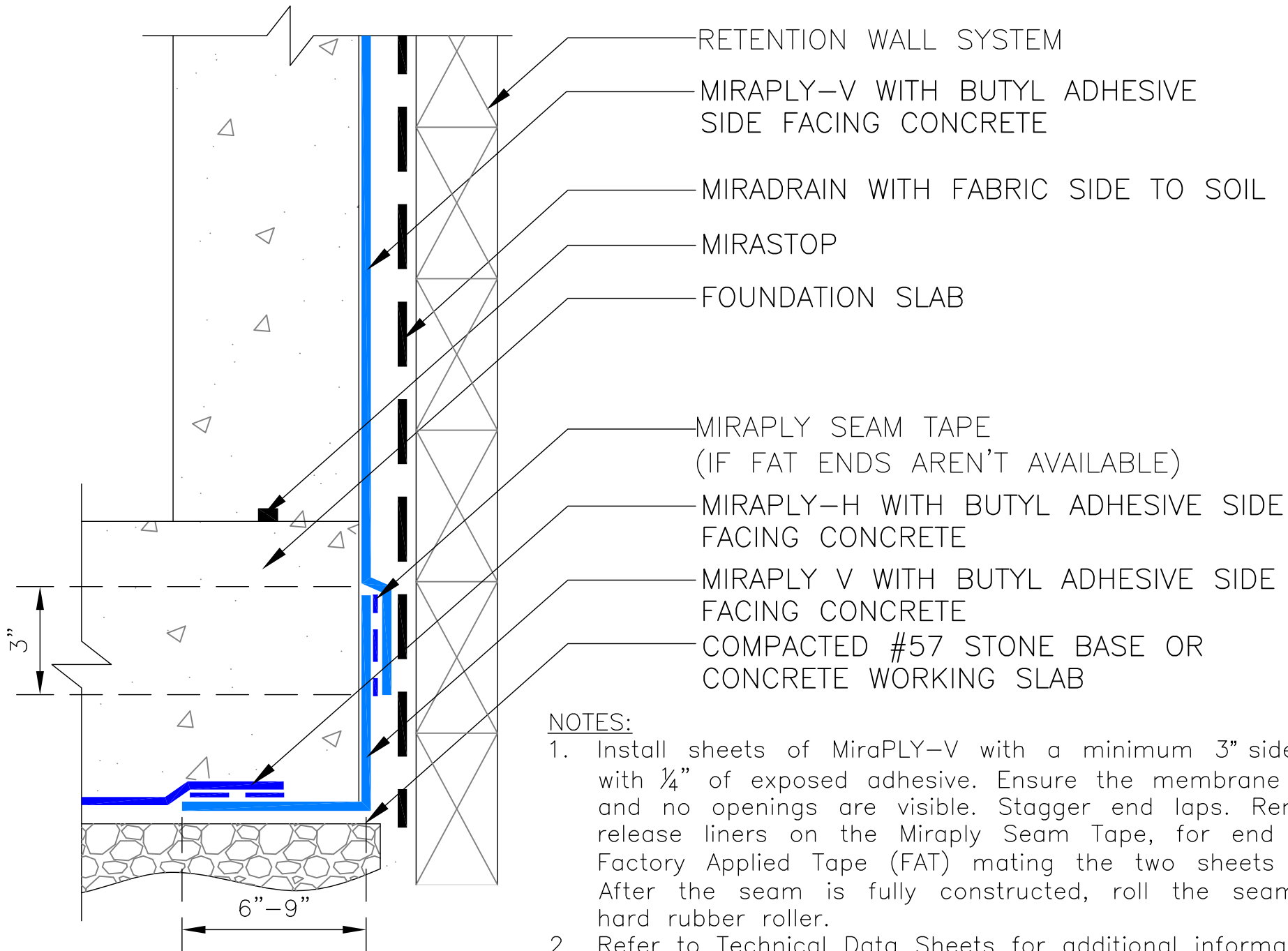

NOTES:

1. Install sheets of MiraPLY-V with a minimum 3" side overlap with $\frac{1}{4}$ " of exposed adhesive. Ensure the membrane lays flat and no openings are visible. Stagger end laps. Remove the release liners on the Miraply Seam Tape, for end lap, and Factory Applied Tape (FAT) mating the two sheets together. After the seam is fully constructed, roll the seam with a hard rubber roller.
2. Refer to Technical Data Sheets for additional information.

DETAIL IS INTENDED TO BE A GUIDE FOR
WATERPROOFING INSTALLATION ONLY.

MiraPLY™ BLINDSIDE WATERPROOFING

02/24/2020

N.T.S.

MP-109

MIRAPLY-H TO MIRAPLY-V
FOUNDATION TIE-IN

CARLISLE
COATINGS & WATERPROOFING

© 2020 CARLISLE CORPORATION

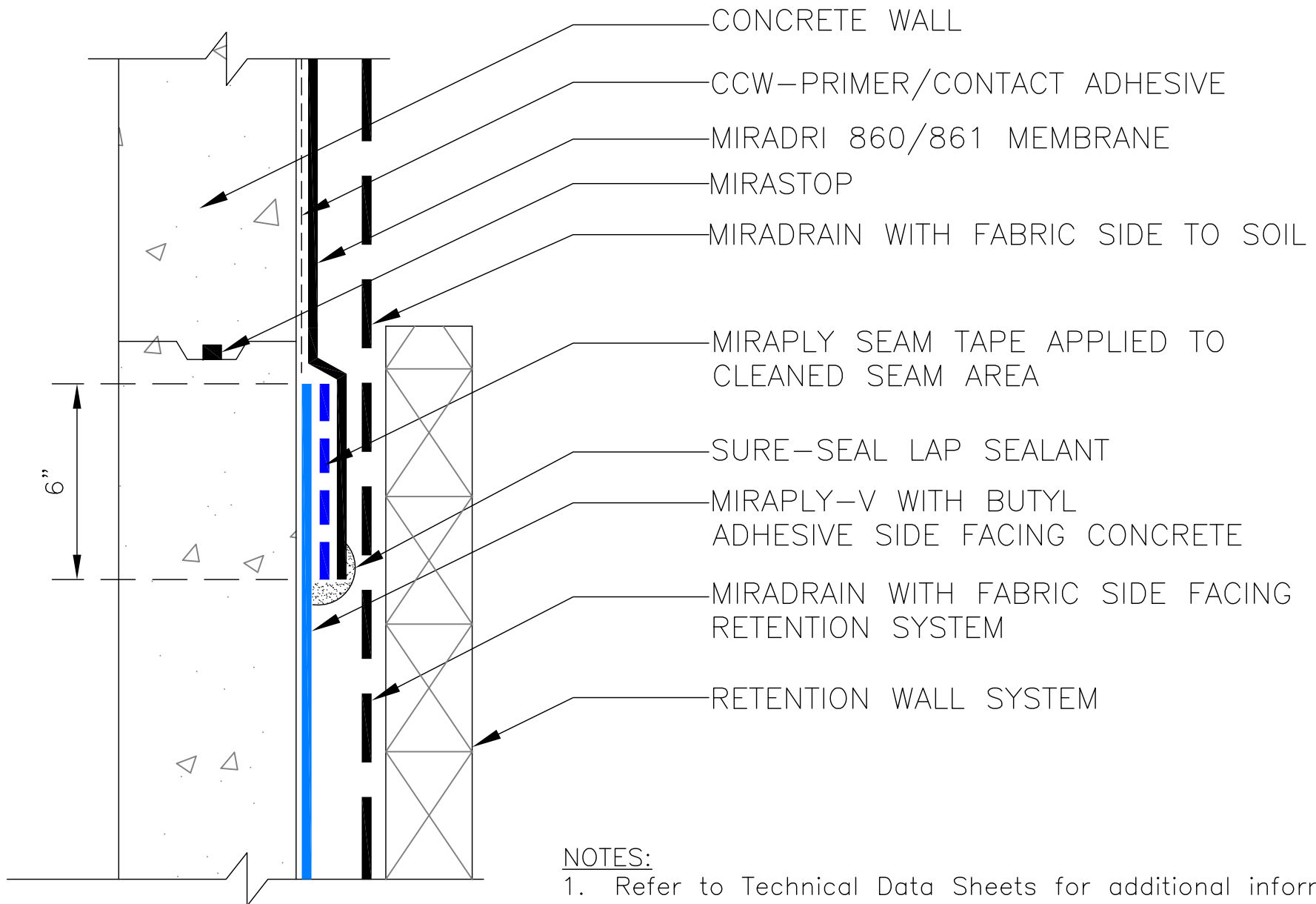

DETAIL IS INTENDED TO BE A GUIDE FOR WATERPROOFING INSTALLATION ONLY.

MiraPLY™ BLINDSIDE WATERPROOFING

02/24/2020

N.T.S.

MIRAPLY-V TO MIRADRI 860
AT VERTICAL WALL

MP-110

CARLISLE
COATINGS & WATERPROOFING

© 2020 CARLISLE CORPORATION

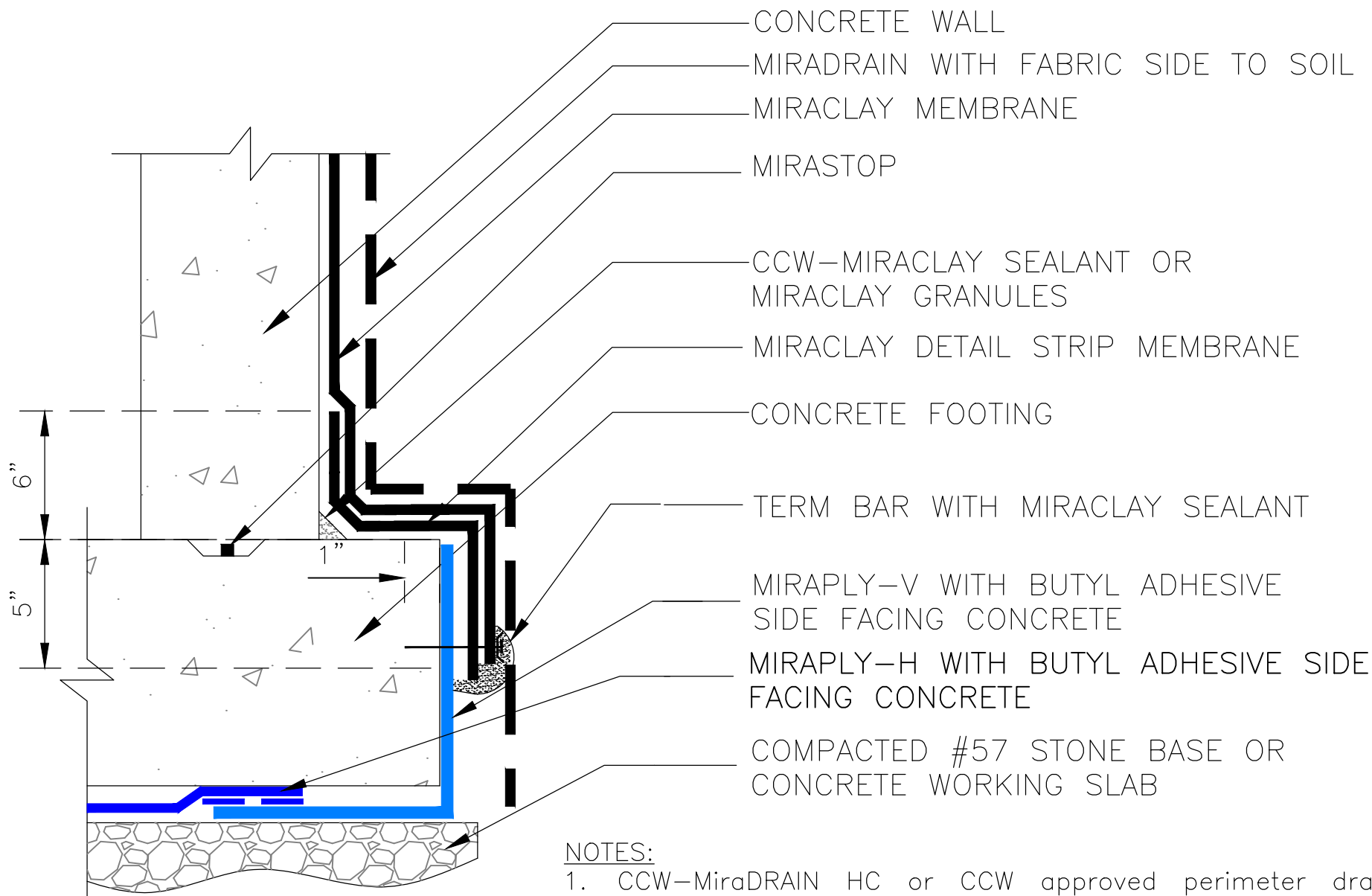

NOTES:

1. CCW—MiraDRAIN HC or CCW approved perimeter drain not shown for clarity.
2. Refer to Technical Data Sheets for additional information.

DETAIL IS INTENDED TO BE A GUIDE FOR WATERPROOFING INSTALLATION ONLY.

MiraPLY™ BLINDSIDE WATERPROOFING

09/24/2021

N.T.S.

MP—111

MIRAPLY—H TO MIRACLAY
AT FOOTING TIE—IN

CARLISLE
COATINGS & WATERPROOFING
© 2021 CARLISLE CORPORATION

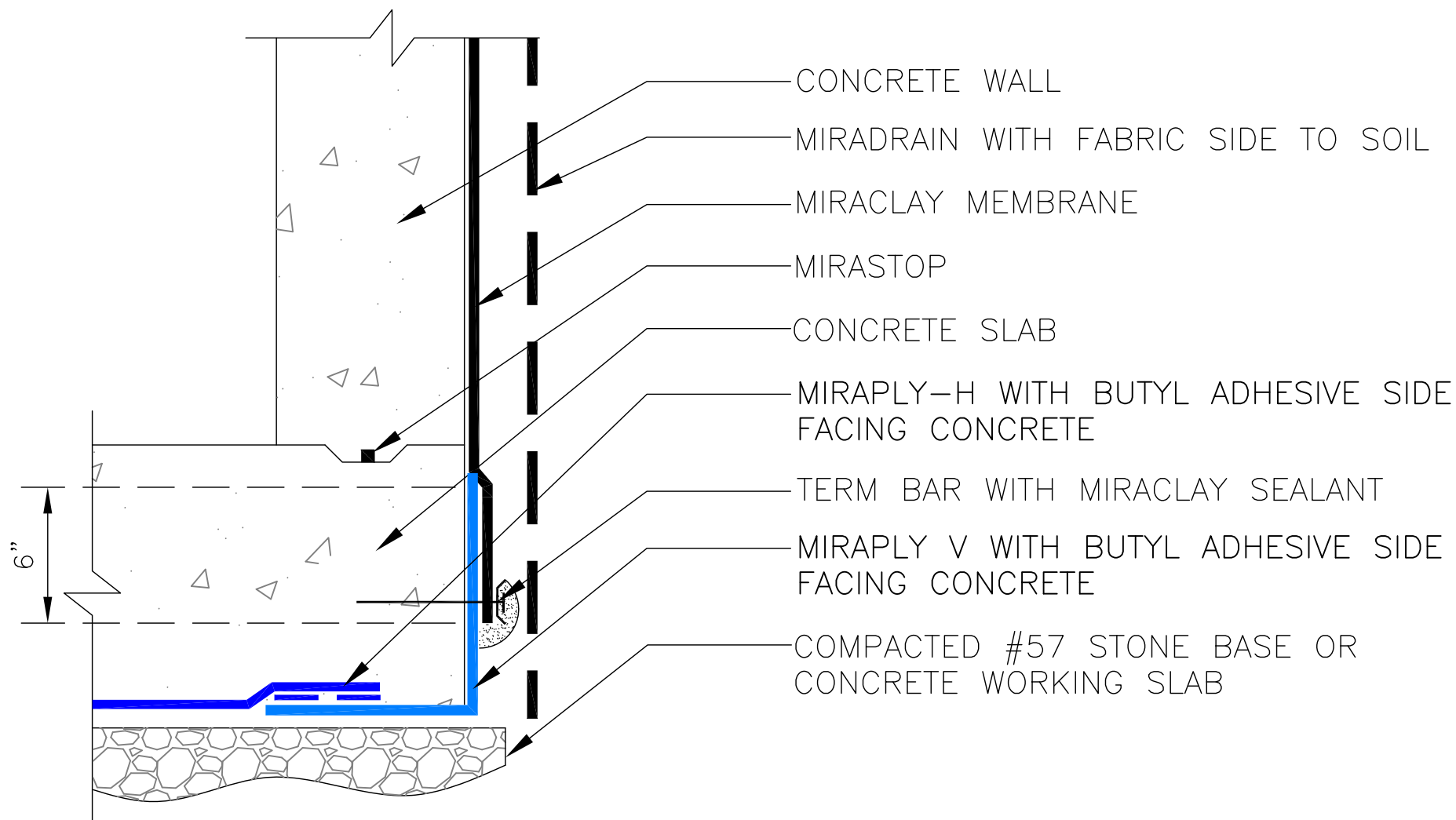

NOTES:

1. Refer to Technical Data Sheets for additional information.

DETAIL IS INTENDED TO BE A GUIDE FOR
WATERPROOFING INSTALLATION ONLY.

8/21/2019

N.T.S.

MP-112

MiraPLY™ BLINDSIDE WATERPROOFING

MIRAPLY-H TO MIRACLAY
AT SLAB TIE-IN

CARLISLE
COATINGS & WATERPROOFING

© 2019 CARLISLE CORPORATION

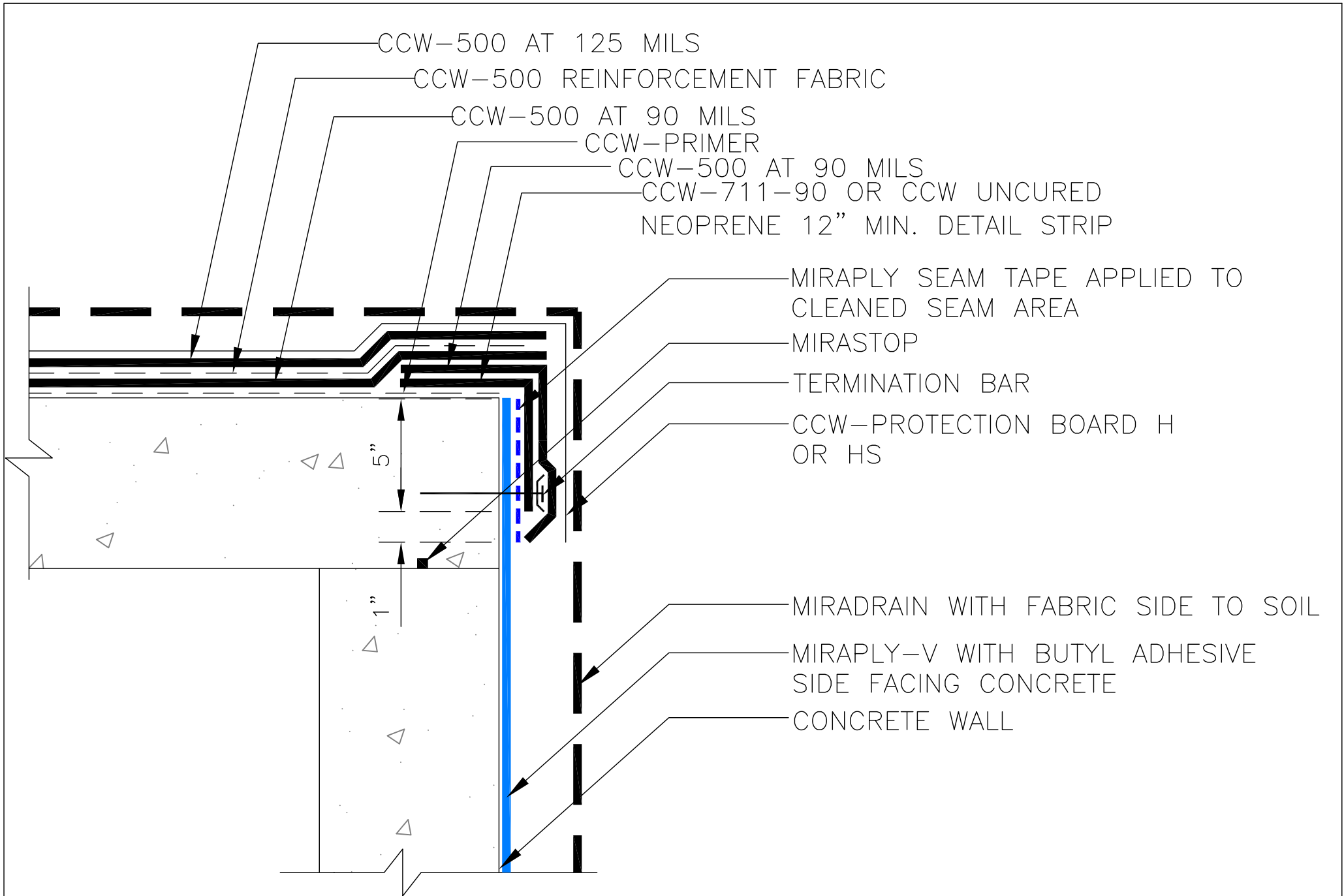

DETAIL IS INTENDED TO BE A GUIDE FOR
WATERPROOFING INSTALLATION ONLY.

MiraPLY™ BLINDSIDE WATERPROOFING

02/24/2020

N.T.S.

MP-113

MIRAPLY-V TO CCW-500R
SYSTEM TIE-IN

CARLISLE
COATINGS & WATERPROOFING

© 2020 CARLISLE CORPORATION

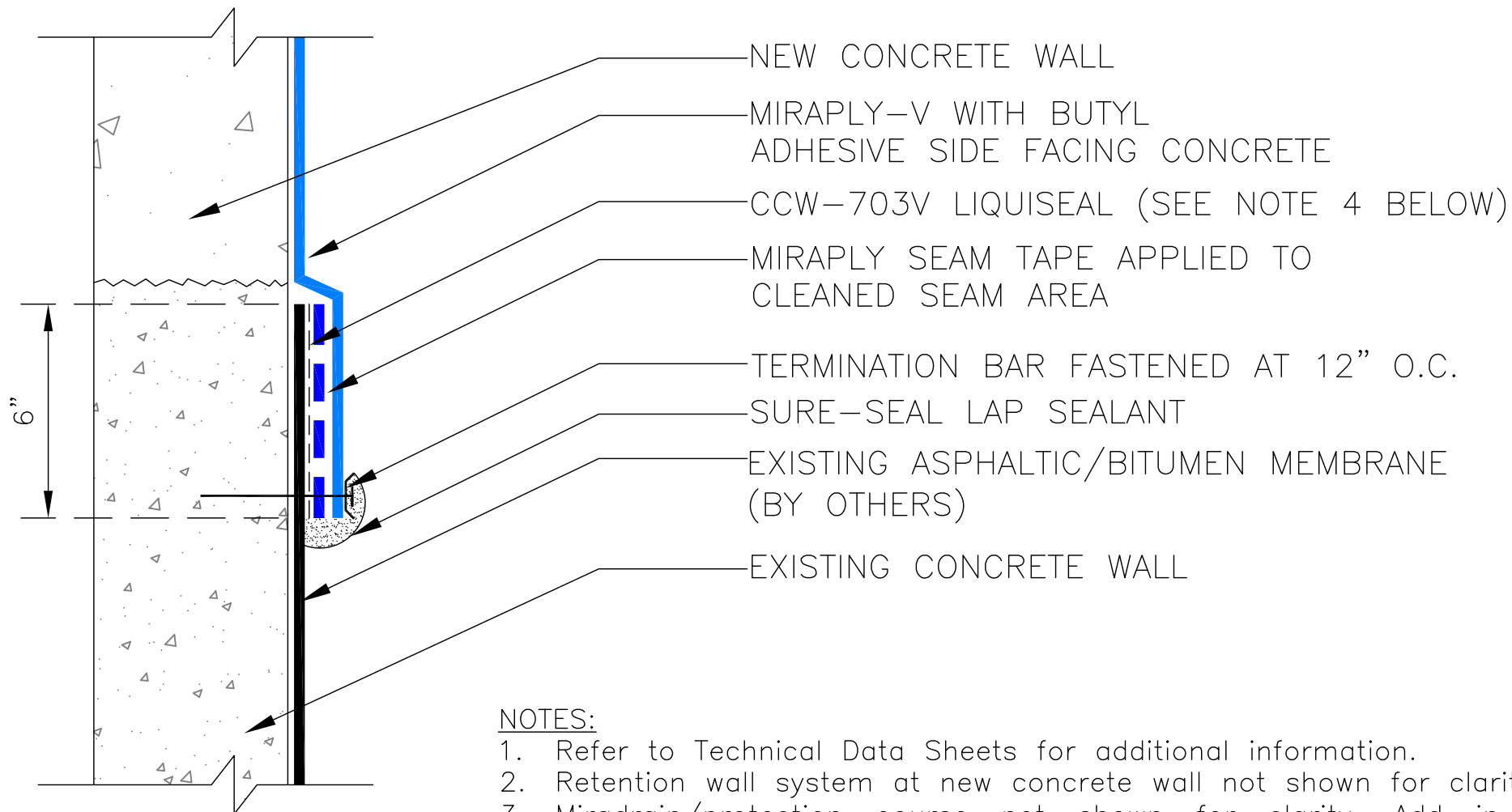

PLAN VIEW

NOTES:

1. Refer to Technical Data Sheets for additional information.
2. Retention wall system at new concrete wall not shown for clarity.
3. Miradrain/protection course not shown for clarity. Add in as required to complete the system.
4. Add CCW-703V Liquiseal 6" strip over existing membrane and under the shown Miraply Seam Tape when the existing membrane type is unknown. Allow the CCW-703V Liquiseal to cure a minimum of 12 hrs prior to applying the Miraply Seam Tape.

DETAIL IS INTENDED TO BE A GUIDE FOR WATERPROOFING INSTALLATION ONLY.

MiraPLY™ BLINDSIDE WATERPROOFING

02/24/2020

N.T.S.

MP-114

MIRAPLY-V TO OTHERS MEMBRANE

CARLISLE
COATINGS & WATERPROOFING

© 2020 CARLISLE CORPORATION